

NOTES

DIMENSIONS SHOWN FOR TARMAC ARE TAKEN FROM THE OUTSIDE OF THE PRE-CAST CONCRETE EDGE. DIMENSIONS SHOWN FOR EQUIPMENT ARE TAKEN FROM THE OUTERMOST FACE.

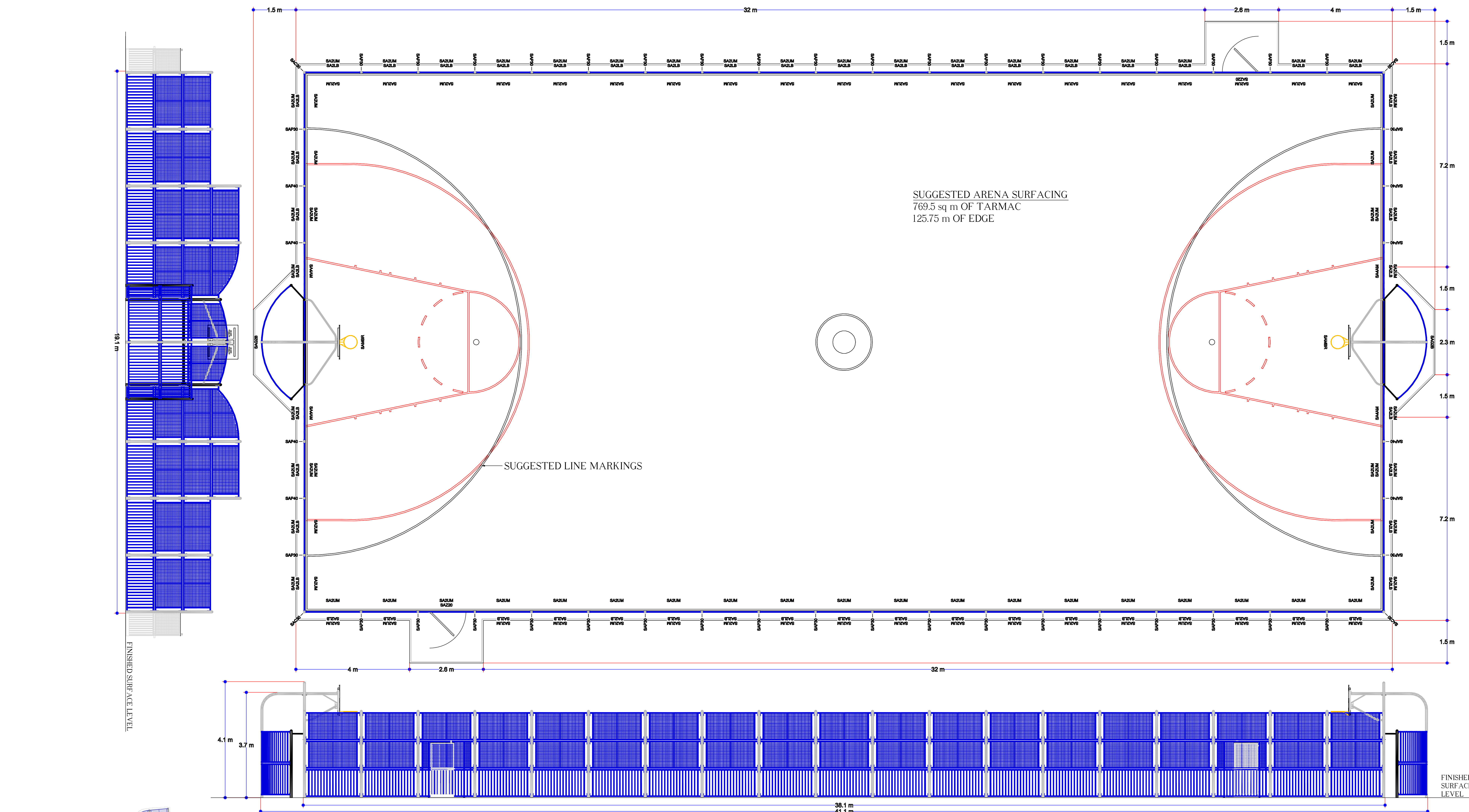

SUGGESTED ARENA SURFACING
769.5 sq m OF TARMAC
125.75 m OF EDGE

SUGGESTED LINE MARKINGS

Components List
ARENA CINCINNATI (SA-CC)
Drawing No:39564_Item1

Code	Description	Qty	Extended Weight (kgs)	Extended Concrete
SA2LB	LOWER BAR FRAME 2M	52	2,059.20	0.00
SA2UM	UPPER MESH FRAME 2M	106	3,349.60	0.00
SA4AM	4.0M HIGH STEP DOWN PNL	4	217.04	0.00
SAC30	3.0M HIGH CORNER POST	4	104.00	0.25
SAG2B	GOAL SECTION	2	708.00	2.02
SAMBR	1.2M REACH BOARD & HOOP	2	188.94	0.00
SAP30	3.0M HIGH POST	40	1,040.00	2.52
SAP40	4.0M HIGH POST	8	344.00	0.79
SAZ20	ZAUN 1.2m S/C GATE 2m HT	2	186.00	0.41
		220	8,196.78	5.99

ARENA STEELWORK COLOURS TO BE CONFIRMED WITH ORDER

REFER TO ARENA INSTALLATION INSTRUCTIONS FOR COMPONENT ID AND INSTALLATION

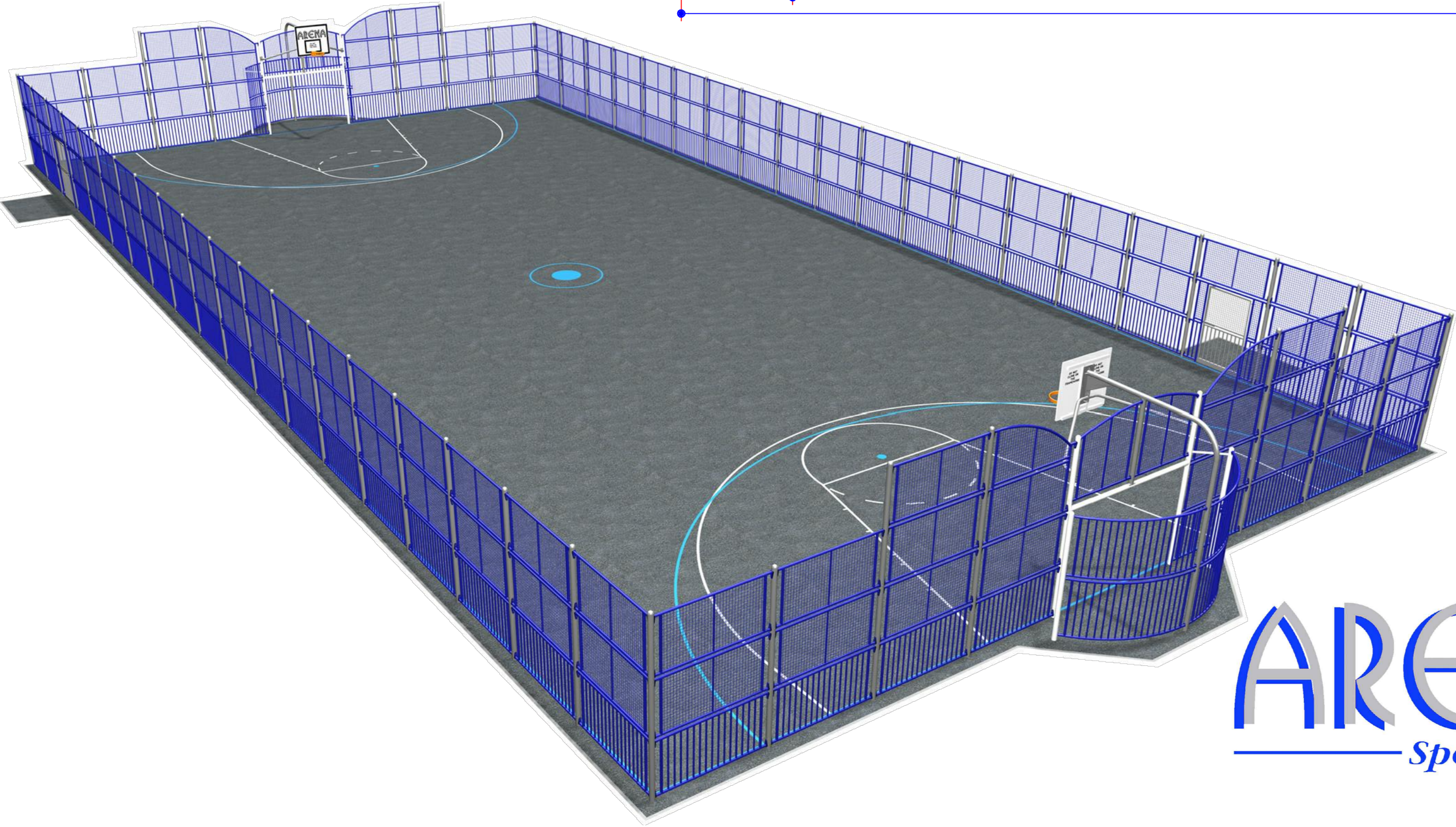

REVISION

DATE	DESCRIPTION	ISSUE
05/10/07	Original	ISSUE A
04/06/10	Amendment by J.F. Check by N.B. Border amended for international use.	ISSUE B

CUSTOMER

PROJECT

TITLE
ARENA SPORTS SYSTEM
CINCINNATI SA-CC 38m x 19m

DATE 05/10/07 SCALE 1:50 @ A0
DRAWN BY : N.B. CHECKED BY : J.C.

DRAWING No. 39564 ISSUE B

SHEET 1 OF 1