

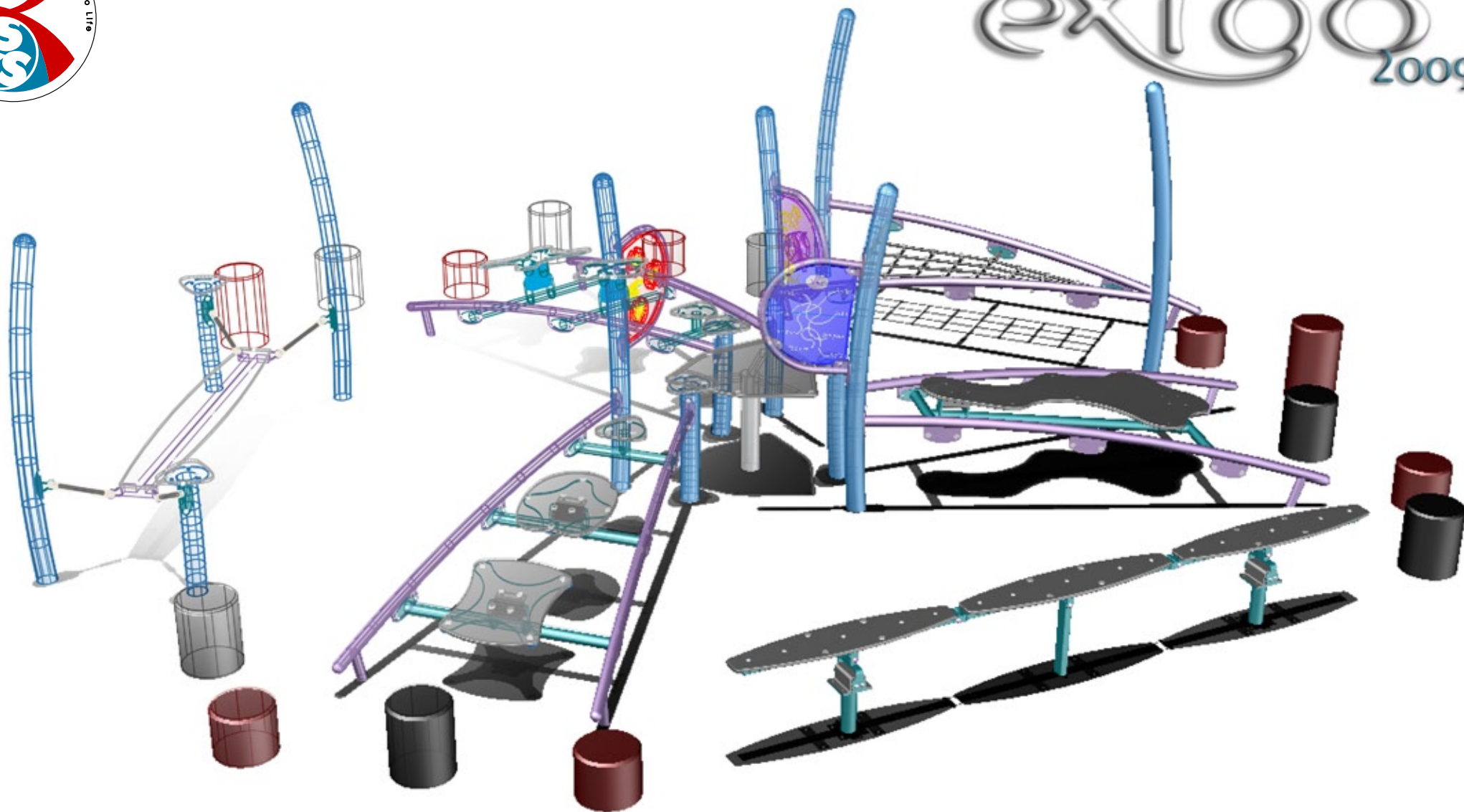

exigo
2009



Installation, inspection & Maintenance Guide 2009



This Page Intentionally Blank



Please read this installation guide in its entirety prior to commencing any installation works

Assembly Instructions.

1. Excavate foundations in accordance with the individual **Footing & Setting Out Drawings**.
2. Assemble the components in the previously excavated foundations. Using the Resistorx driver secure all fixings. (**Refer to individual 3D exploded views**)
3. Backfill foundations with concrete (4:2:1 mix)

Notes.

- The Maximum Free Height of Fall for eXigo is 0.6m
- The Falling space for eXigo is 8.99m x 8.50m
- Constructional space requirements 15m x 15m
- Foundation detail is assuming good ground conditions. **Care should be taken concerning abnormal ground conditions.**
- Check tightness of bolts following a two week run-in period.
- Replacement components must comply with Record RSS Ltd specifications.
- **Warning** - some of these components may exceed the single persons lifting allowance.
- Ensure equipment is protected from usage throughout installation, maintenance and repair.
- Touch-up any damaged paintwork using the Record touch-up paint provided. Ensure affected areas are rubbed down and primed as required.
- Once the installation is complete check all bolts are fully secure and clear the site of any debris.
- Ensure level surface below all equipment.

Assembly aids should be removed prior to the equipment being used



RP001 eXigo Complete Assembly (Rubber bollards omitted)

Note: The HDPE panels illustrated are an optional extra and may not be part of the system to be installed.

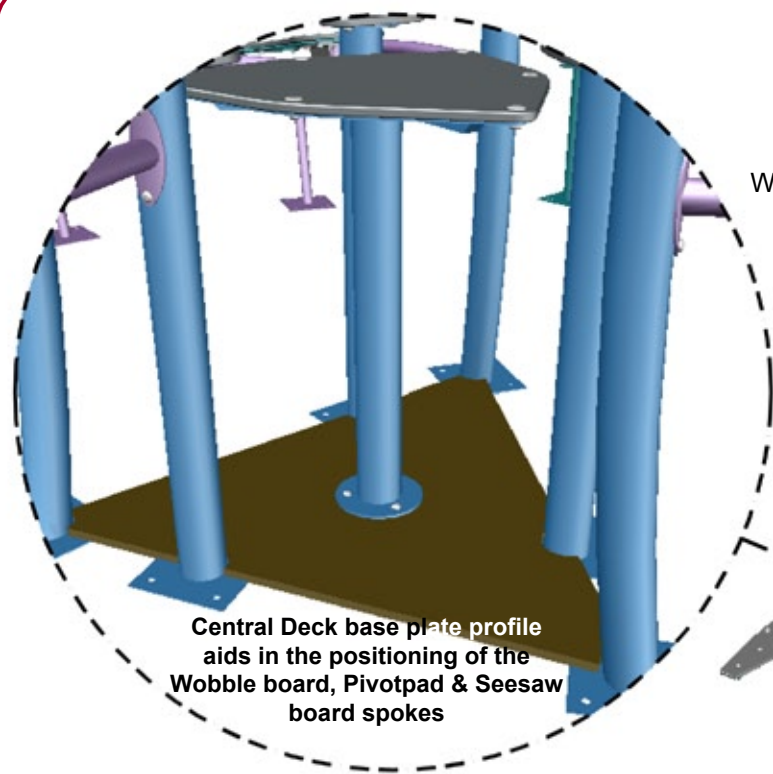

Central Deck base plate profile aids in the positioning of the Wobble board, Pivotpad & Seesaw board spokes

Wave Walk Assembly

Seesaws Board Spoke Assembly

Plank Walk Assembly

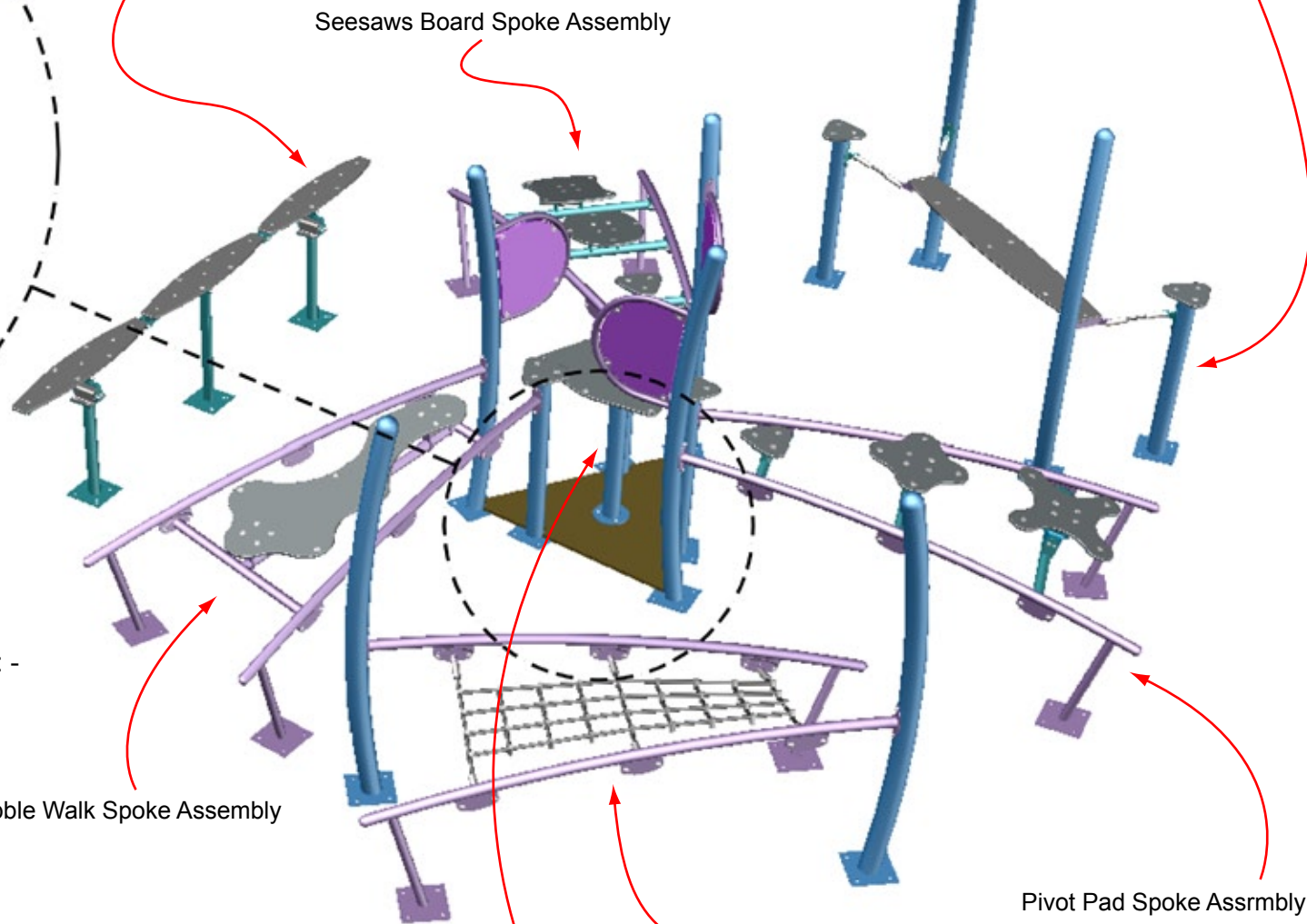

Wobble Walk Spoke Assembly

Pivot Pad Spoke Assrmbly

Rope Bridge Assembly

Central Deck assembly

This sheet to be read in conjunction with the following: -

- Footing Setting Out
- Bollard Setting Out
- Wetpour Setting Out
- Grassmat Setting Out
- Elevation Dimensions
- Pivotpad Exploded and assembled views
- Wobbleboard Exploded and assembled views
- Seesaw board Exploded and assembled views
- Rope bridge exploded and assembled views
- Wavewalk exploded and assembled views
- Plank Walk exploded and assembled views
- Central deck exploded and assembled views



RP001 eXigo Footing Setting Out (excludes bollards)

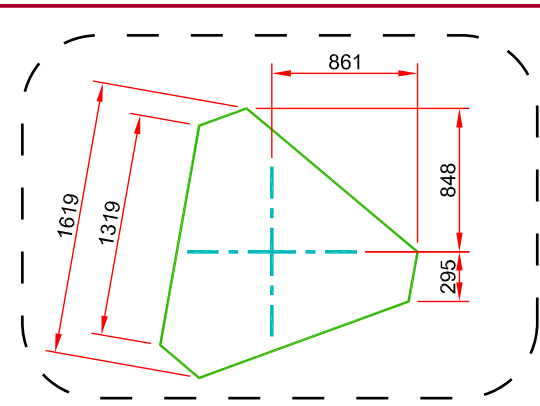
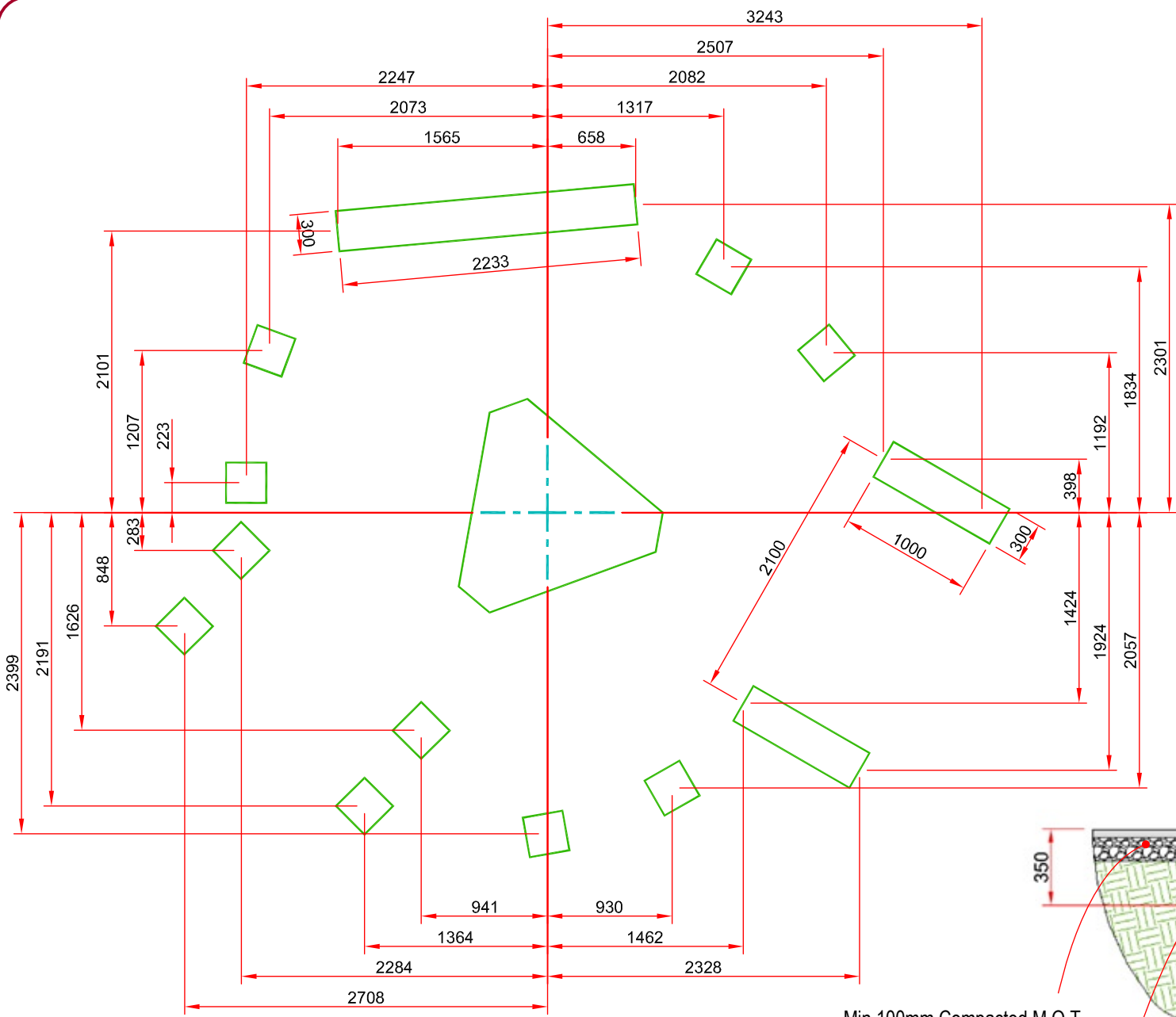

**All footings 300 x 300mm
Depth in accordance with diagram below**

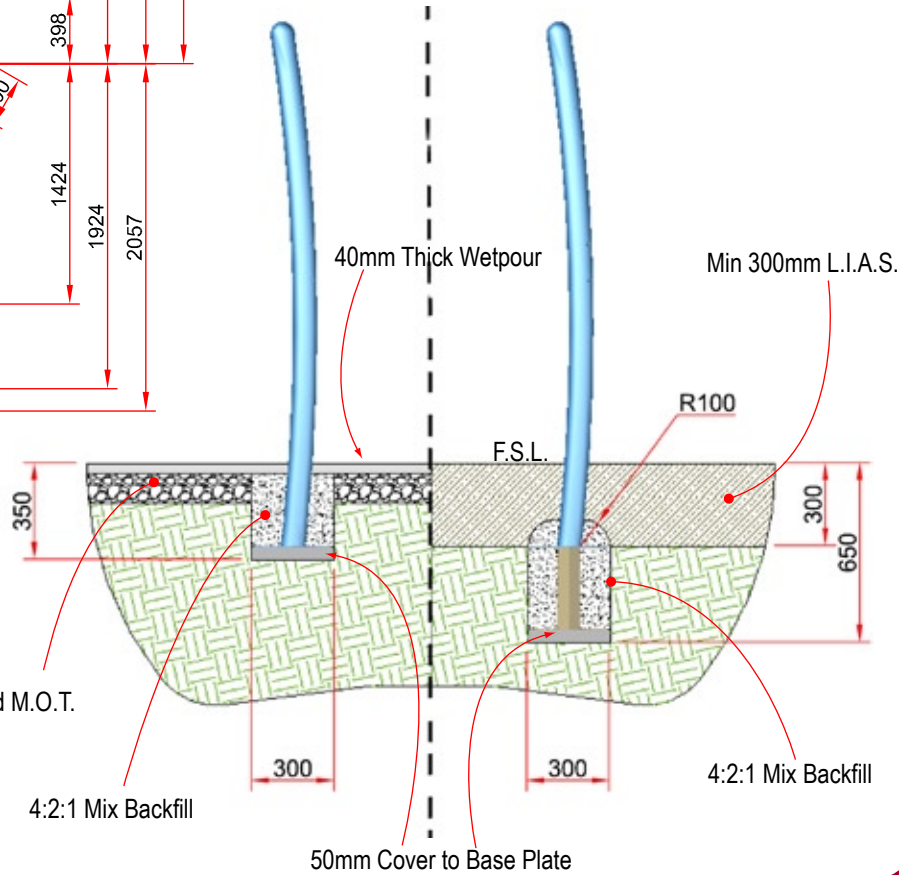

If the installation is with loose fill type surfacing the legs of the system should be marked with a "Basic level mark" to indicate the recommended "Finished surface level" (F.S.L.) of the surface.

Using masking tape, paint a 10mm wide mark around each leg with paint provided.

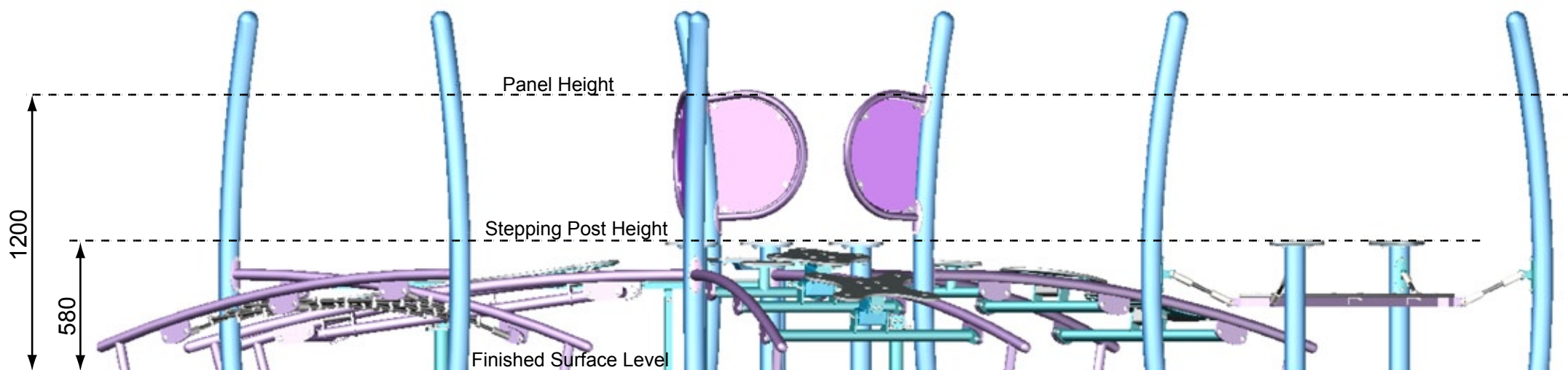

It is essential that, for reasons of conformity to EN1176, the above elevation dimensions are not exceeded.

Requires 64m² Wetpour @ 40mm Thick

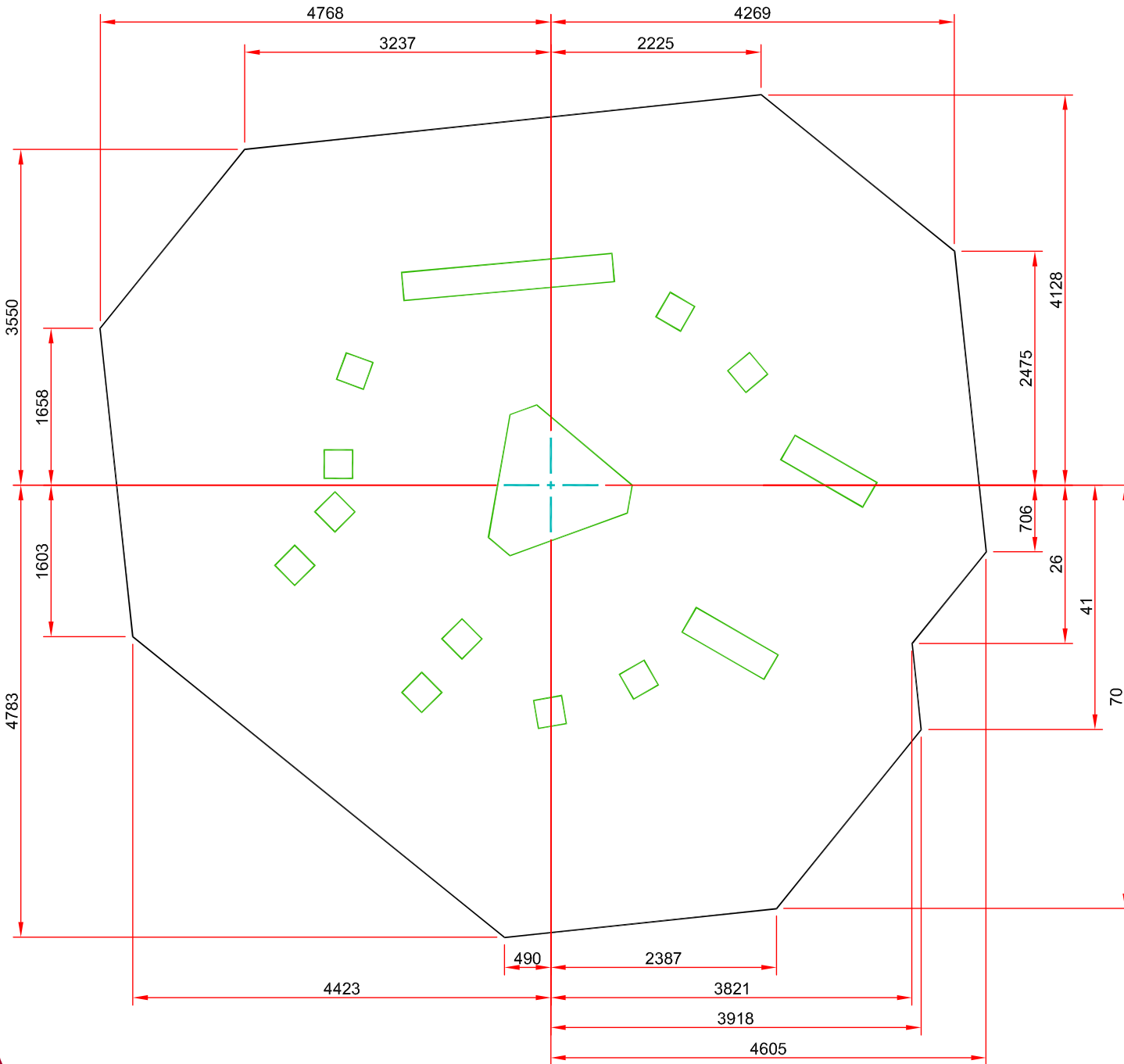
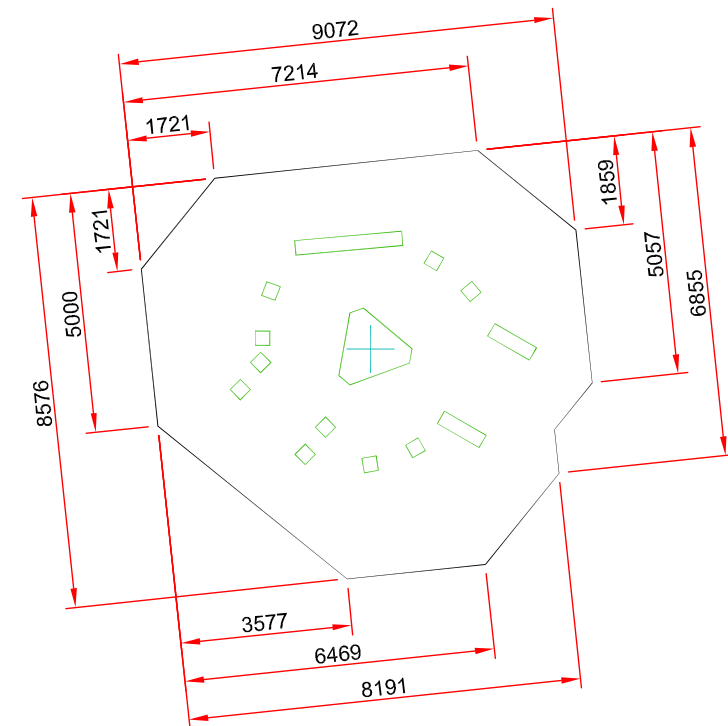
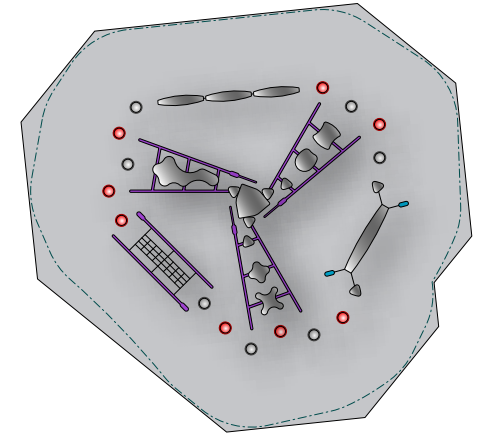

Requires 74.25m² Grassmatt

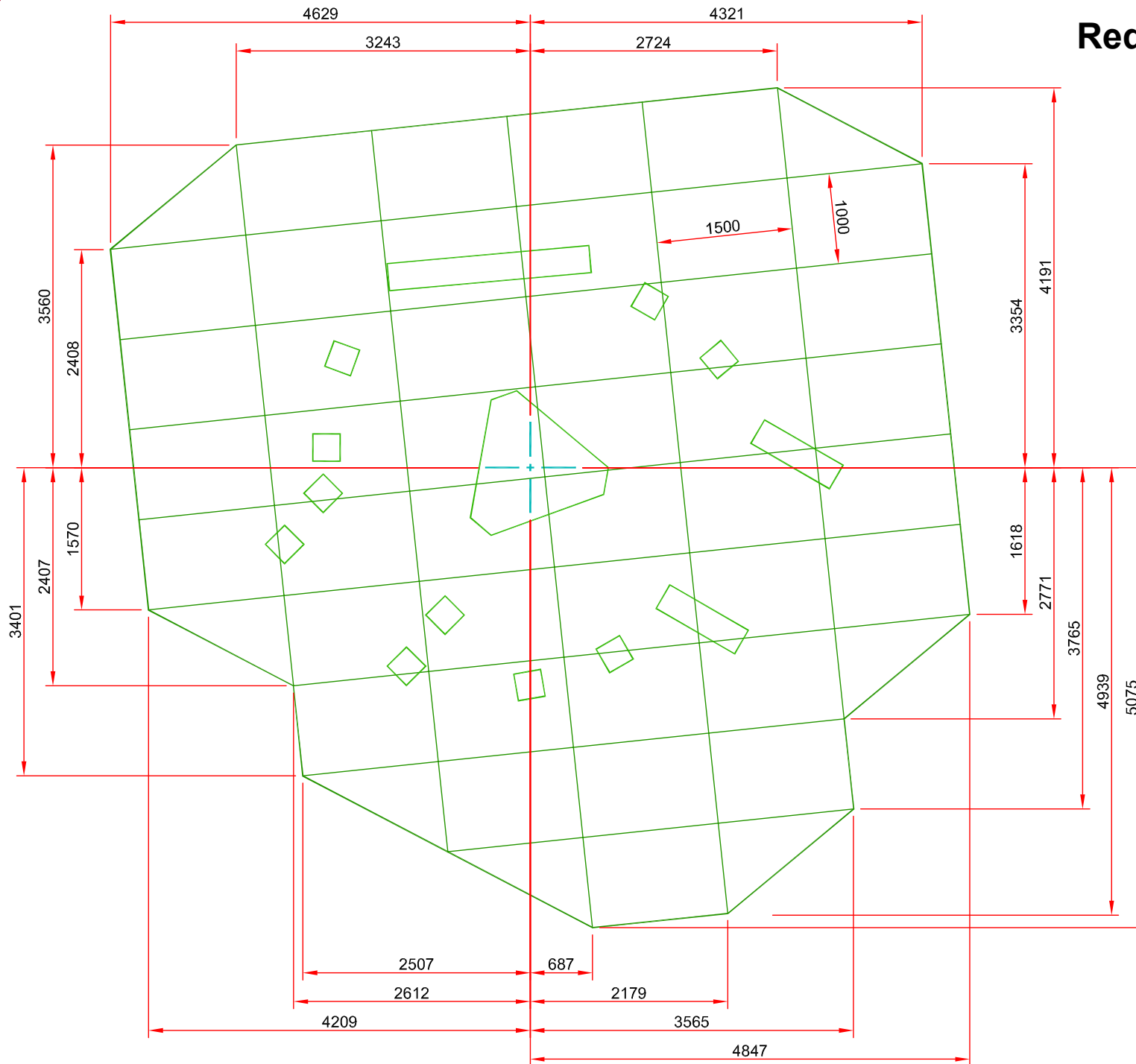

RP001 eXigo Central Deck Assembly (Xi005)

Xi005 eXigo Central Deck		
Code	Description	No Off
804312	Central Deck Support	1
804406	Base Board	1
804420	Central Deck Polydek	1
1021020	M10 x 20 Resistorx	6
10251040	M10 x 40 Hex Head Bolt	3
10271000	M10 Plain Nut	3
10301001	M10 Nylon Washer	6
10931000	M10 Blank T-Nut	6
Additional component for Loosefil Installation		
804321	Central Deck Extension	1
10251040	M10 x 40 Hex Head Bolt	3
10271000	M10 Plain Nut	3

10931000 6 No M10 T-Nut



804420 Central Deck Polydek



10121020 6 No M10 x 20 Resistorx
c/w 10301001 M10 Nylon Washer

804312 Central Deck Support

10251040 3 No M10 x 50 Hex Head Bolt

10271000 M10 Plain Nut

804321 Central Deck Extension
(Only for Loose Fill Installation)

804406 Central Deck Base Board

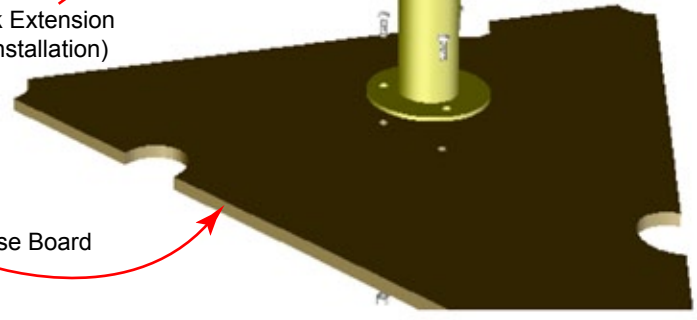

Assembly Sequence: -

1. Assemble unit as indicated in the previously excavated footings (see footing layout for details).
2. Once the rest of the system has been correctly assembled back fill footings with Concrete @ 4:2:1 mix.

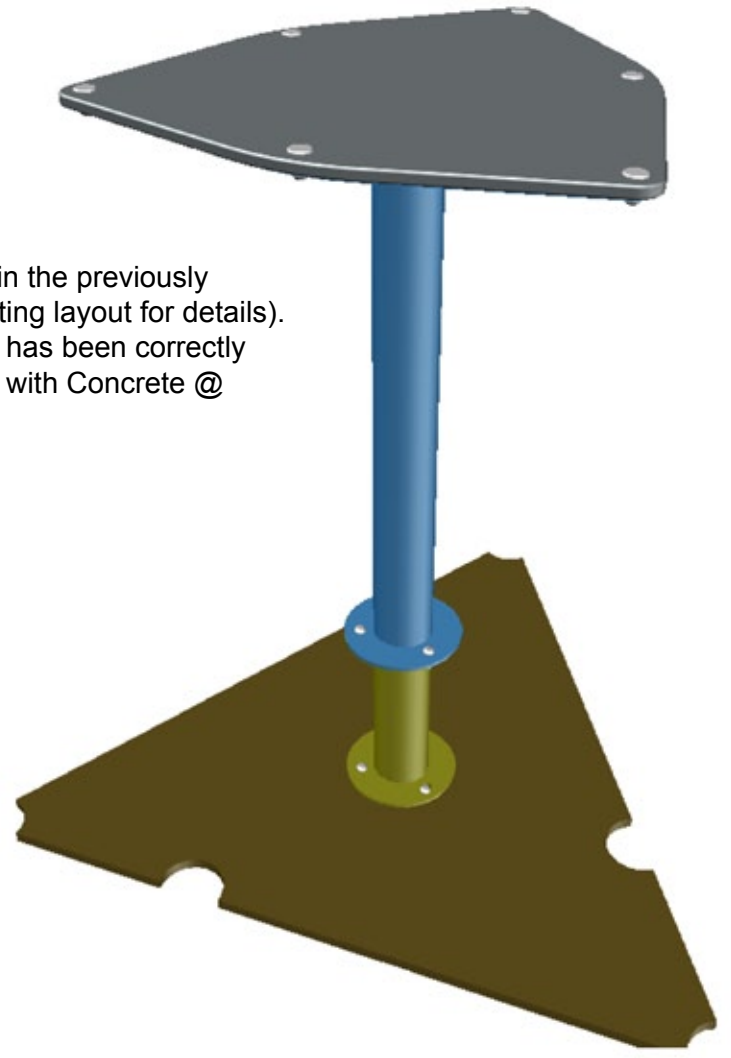



RP001 eXigo Pivot Pad Spoke Exploded View (Xi006)

Xi006 Pivot Pad Spoke		
Code	Description	No Off
804107	Medium Pivot Pad Assembly	1
804108	Large Pivot Pad Assembly	1
804109	Small Static Board Assembly	1
804302	Main Spoke	2
804304	Main Upright Post	1
804316	Low Upright Post	1
804421	Step Polydek	1
804434	Elliptical Neoprene Gasket	8
804443	5mm Thick Spacer Washer	12
10121020	M10 x 20 Resistorx	15
10121030	M10 x 30 Resistorx	4
10301001	M10 Nylon Washer	19
10301004	M10 x 20 Barrel Bolt	12
10931000	M10 Blank T-Nut	3

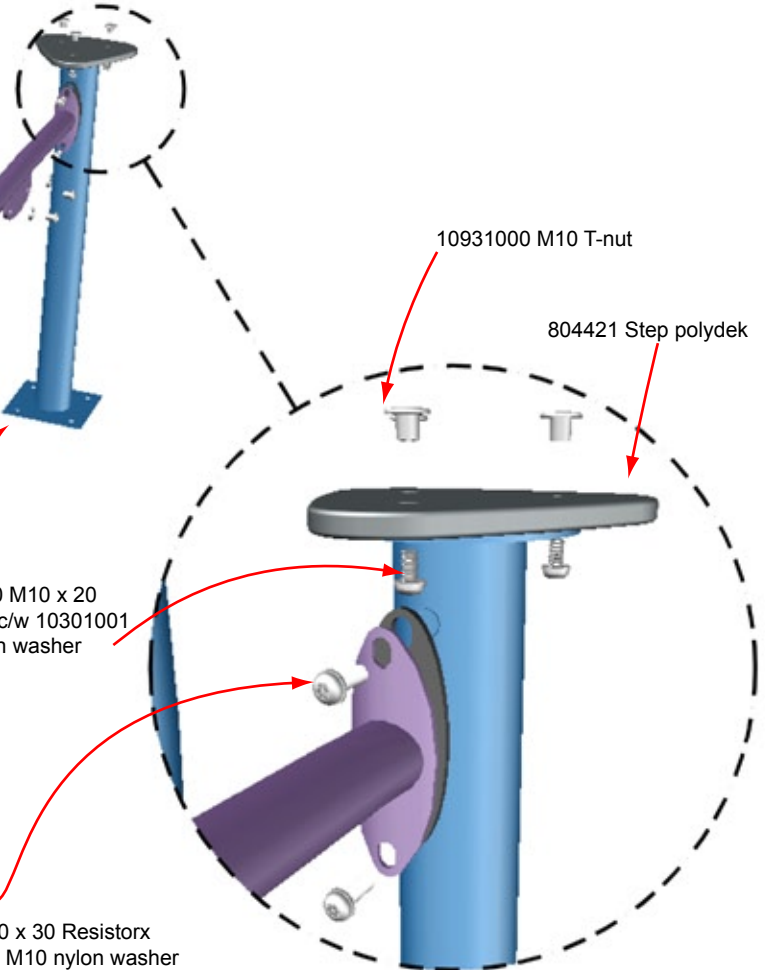
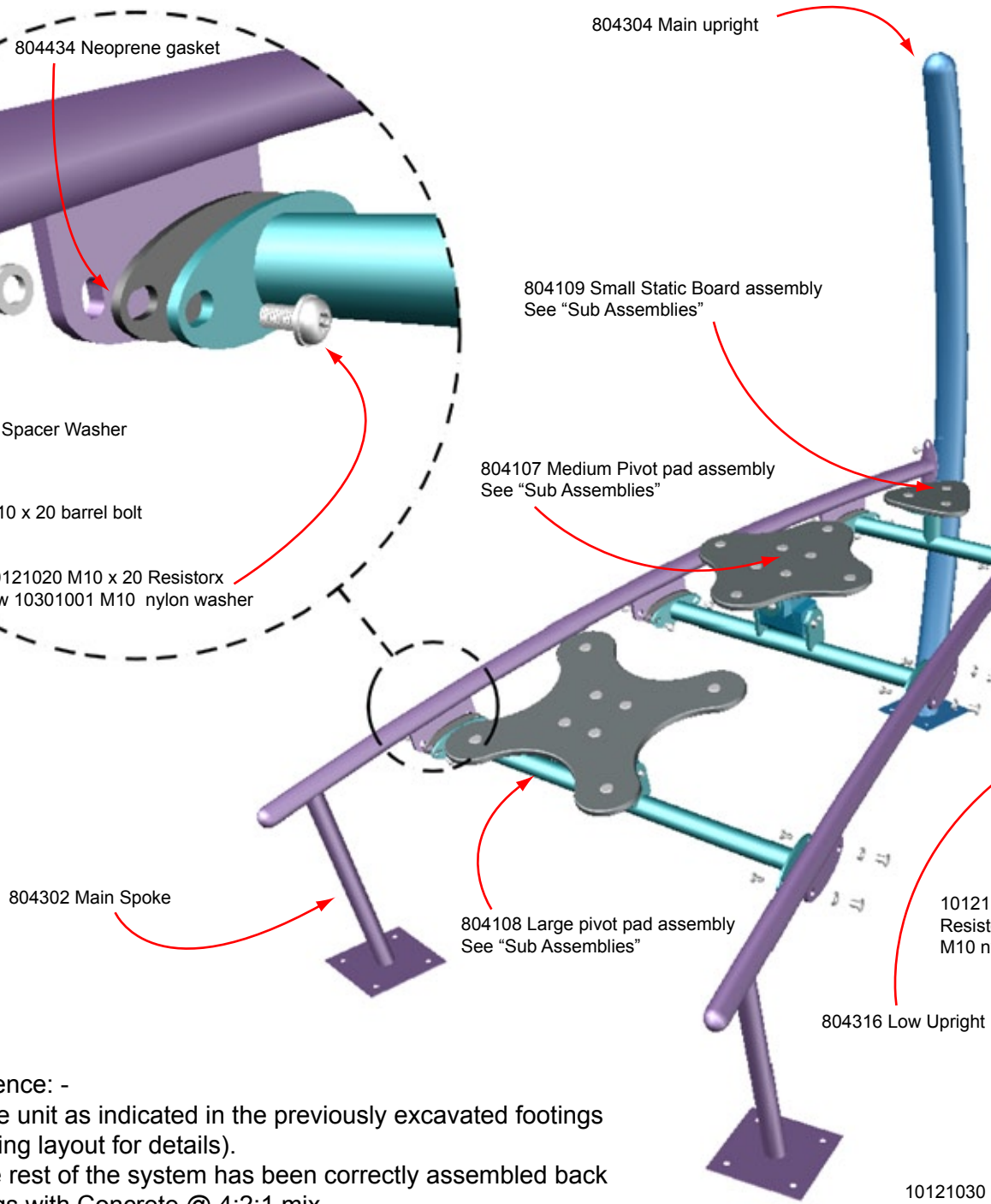
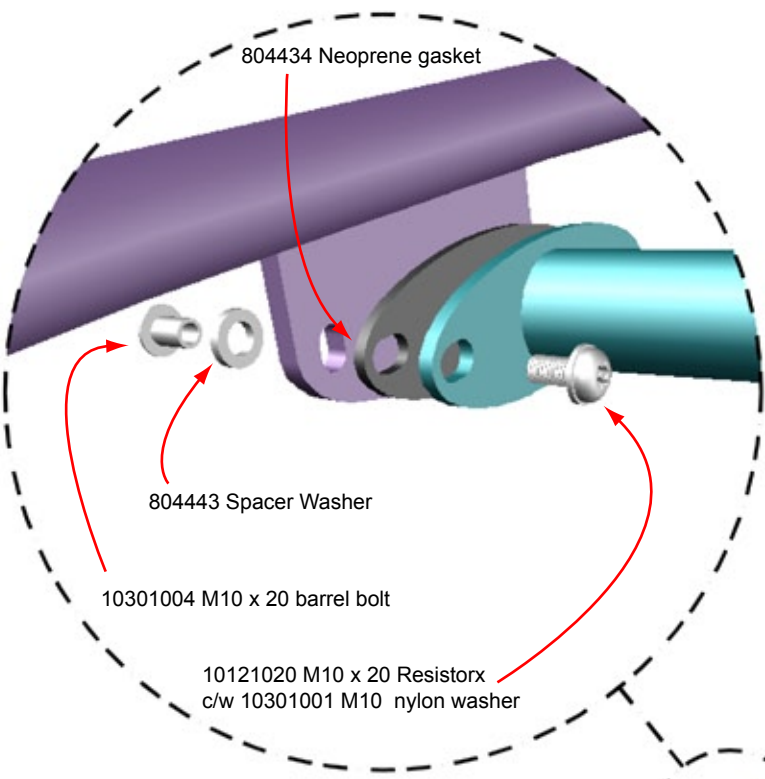

Assembly Sequence: -

1. Assemble unit as indicated in the previously excavated footings (see footing layout for details).
2. Once the rest of the system has been correctly assembled back fill footings with Concrete @ 4:2:1 mix.

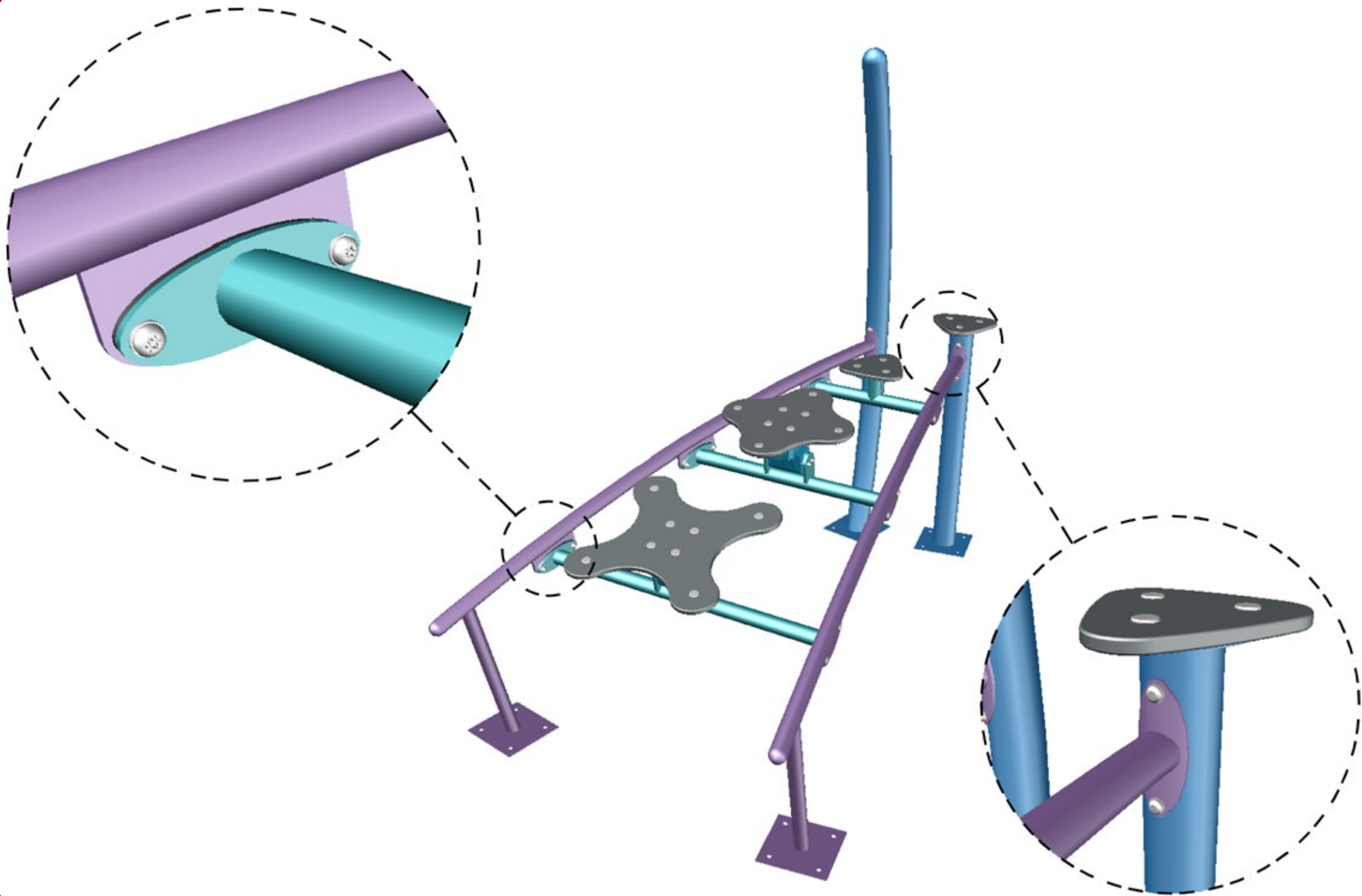

RP001 eXigo Seesaw Spoke Exploded View (Xi007)

Xi007 Seesaw Board Spoke		
Code	Description	No Off
804110	Medium Seesaw Board Assembly	1
804109	Small Static Board Assembly	1
804111	Large Seesaw Board Assembly	1
804302	Main Spoke	2
804304	Main Upright Post	1
804316	Low Upright Post	1
804421	Step Polydek	1
804434	Elliptical Neoprene Gasket	8
804443	5mm Thick Spacer Washer	12
10121020	M10 x 20 Resistorx	15
10121030	M10 x 30 Resistorx	4
10301001	M10 Nylon Washer	19
10301004	M10 x 20 Barrel Bolt	12
10931000	M10 Blank T-Nut	3

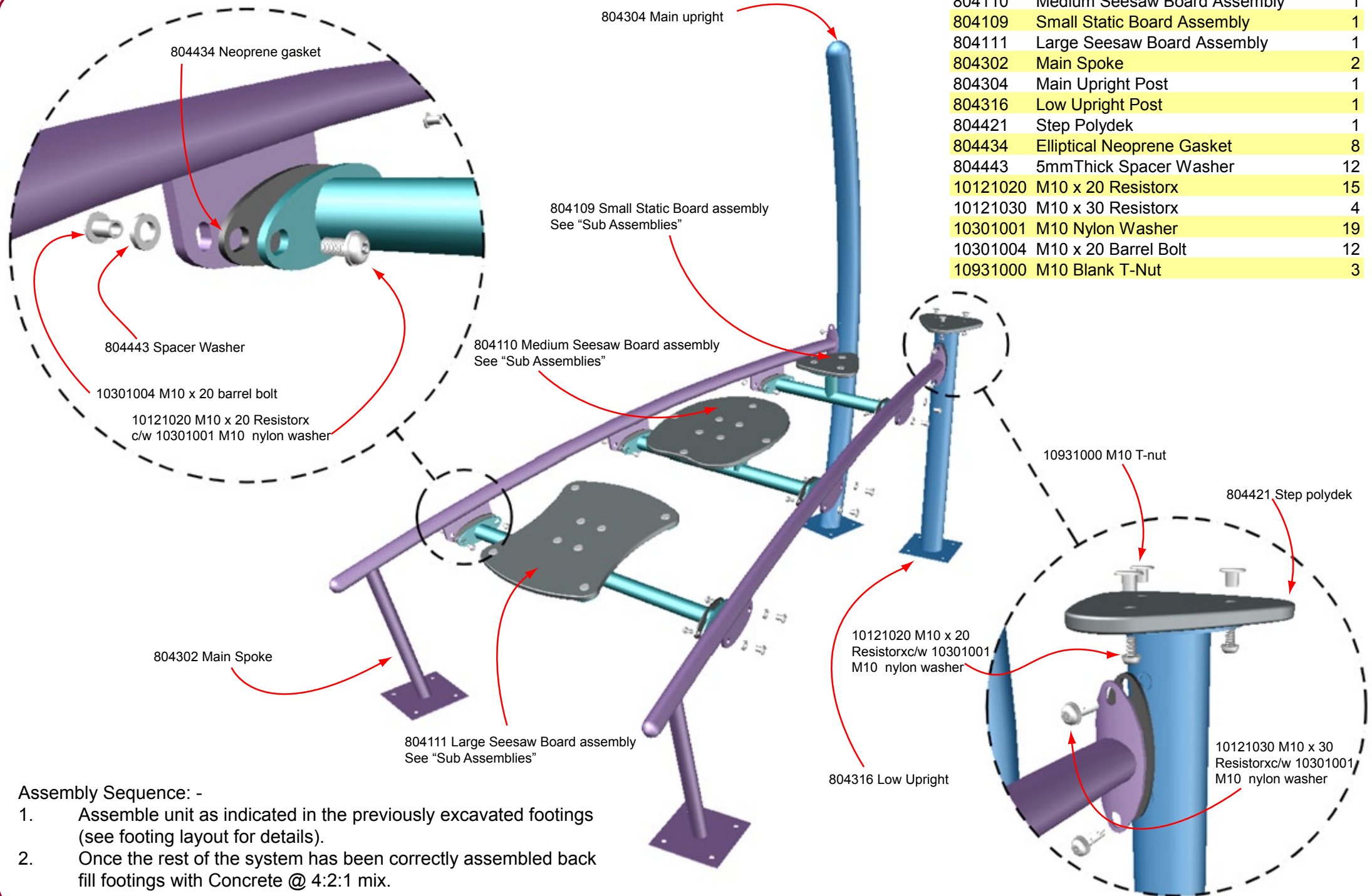

Assembly Sequence: -

1. Assemble unit as indicated in the previously excavated footings (see footing layout for details).
2. Once the rest of the system has been correctly assembled back fill footings with Concrete @ 4:2:1 mix.

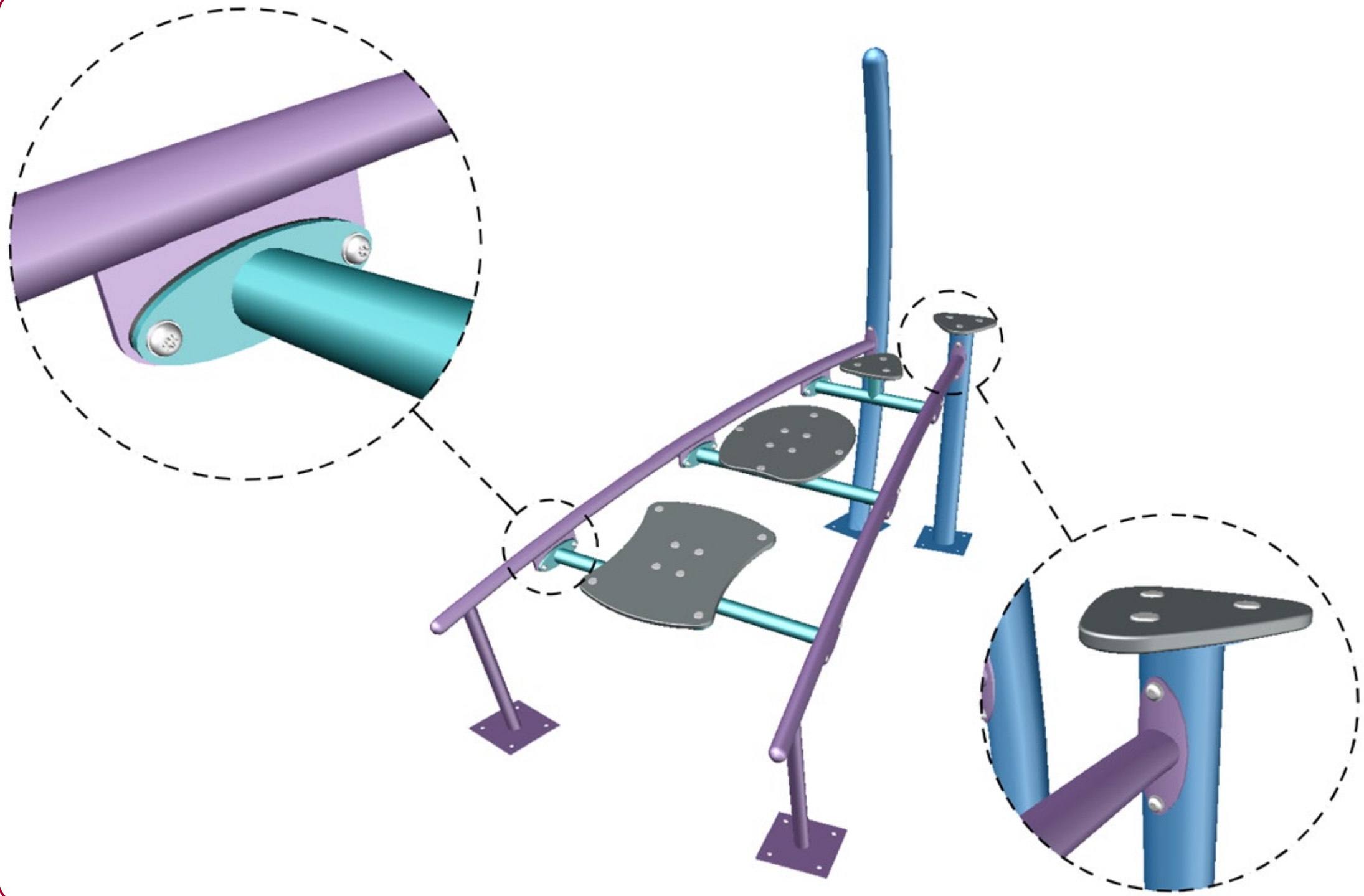



RP001 eXigo Wobble Board Spoke Exploded View (Xi008)

Xi008 Wobble Board Spoke		
Code	Description	No Off
804112	Wobble Board Assembly	1
804302	Main Spoke	2
804304	Main Upright Post	1
804316	Low Upright Post	1
804421	Step Polydek	1
804434	Elliptical Neoprene Gasket	6
804443	5mm Thick Spacer Washer	8
10121020	M10 x 20 Resistorx	11
10121030	M10 x 30 Resistorx	4
10301001	M10 Nylon Washer	15
10301004	M10 x 20 Barrel Bolt	8
10931000	M10 Blank T-Nut	3

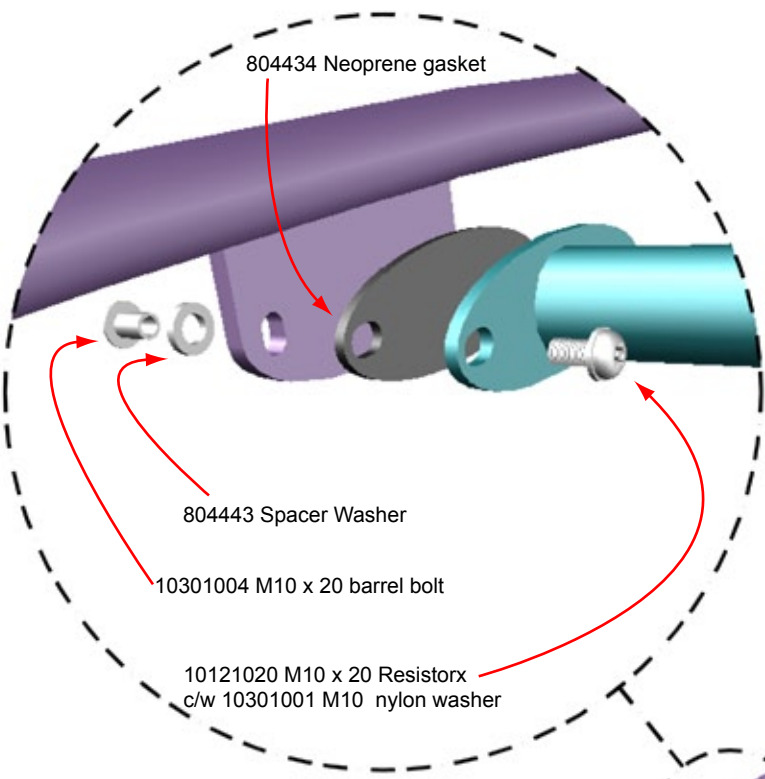

804304 Main upright

804302 Main Spoke

804112 Wobble Board assembly
See "Sub Assemblies"

10121020 M10 x 20
Resistorx c/w 10301001
M10 nylon washer

804316 Low Upright

10931000 M10 T-nut 804421 Step polydek

10121030 M10 x 30 Resistorx
c/w 10301001 M10 nylon washer

Assembly Sequence: -

1. Assemble unit as indicated in the previously excavated footings (see footing layout for details).
2. Once the rest of the system has been correctly assembled back fill footings with Concrete @ 4:2:1 mix.



RP001 eXigo Wobble Board Spoke Assembled View (Xi008)

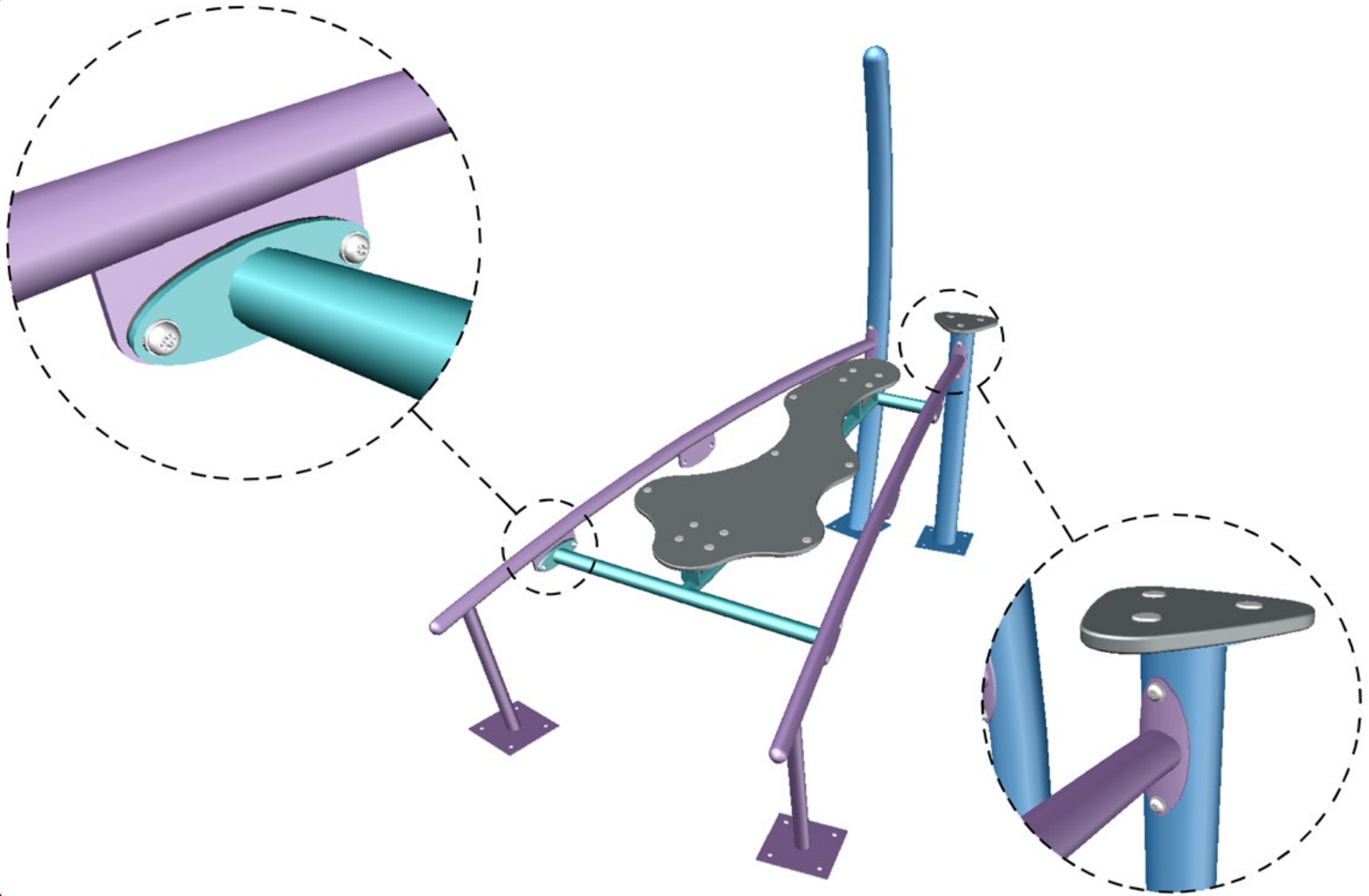



RP001 eXigo Wave Walk Exploded View No 1 (Xi011)

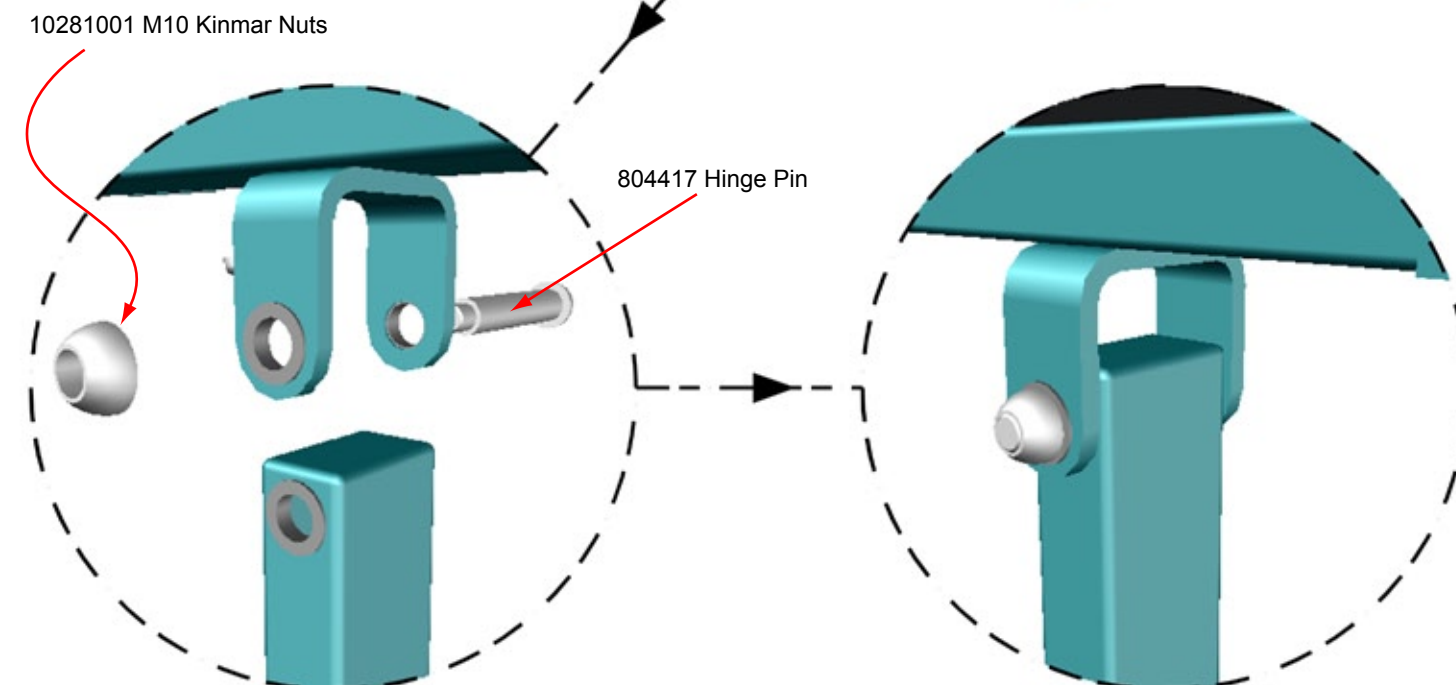
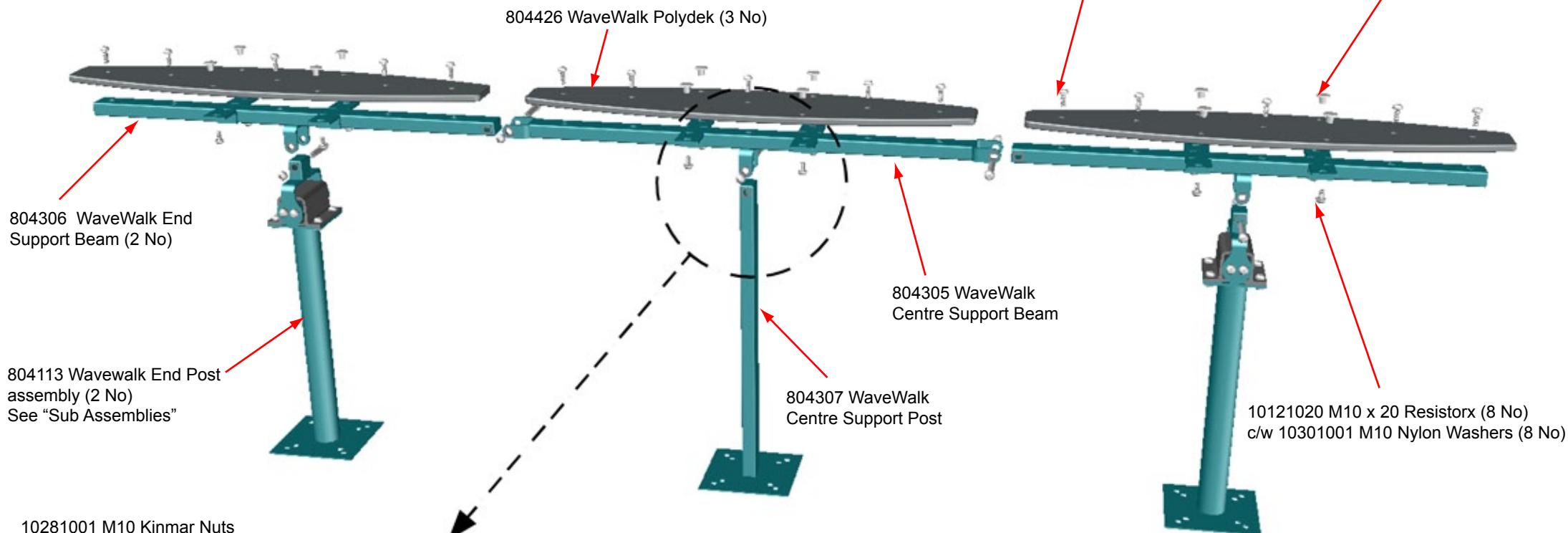

Assembly Sequence: -

1. Assemble unit as indicated in the previously excavated footings (see footing layout for details).
2. Once the rest of the system has been correctly assembled backfill footings with Concrete @ 4:2:1 mix.

Xi011 WaveWalk		
Code	Description	No Off
804113	WaveWalk End Post Assembly	2
804305	WaveWalk Centre Support Beam	1
804306	WaveWalk End Support Beam	2
804307	WaveWalk Centre Support Post	1
804417	WaveWalk Hinge Pin	5
804426	WaveWalk Polydek	3
10121020	M10 x 20 Resistorx	12
10121030	M10 x 30 Resistorx	15
10301001	M10 Nylon Washer	27
10931000	M10 Blank T-Nutt	12
10281001	M10 Kinmar Nuts	10



RP001 eXigo Wave Walk Exploded View No 2 (Xi011)

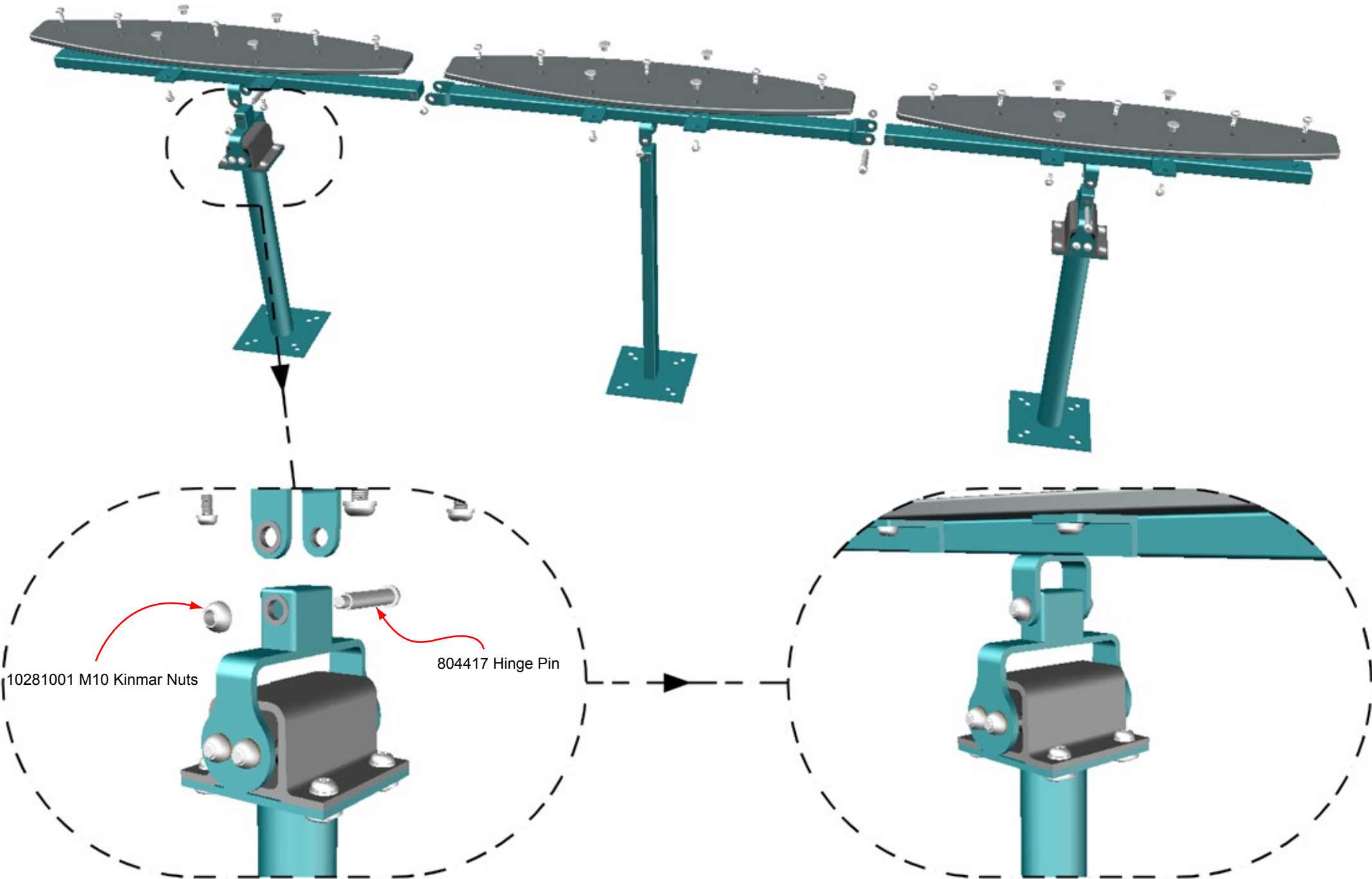

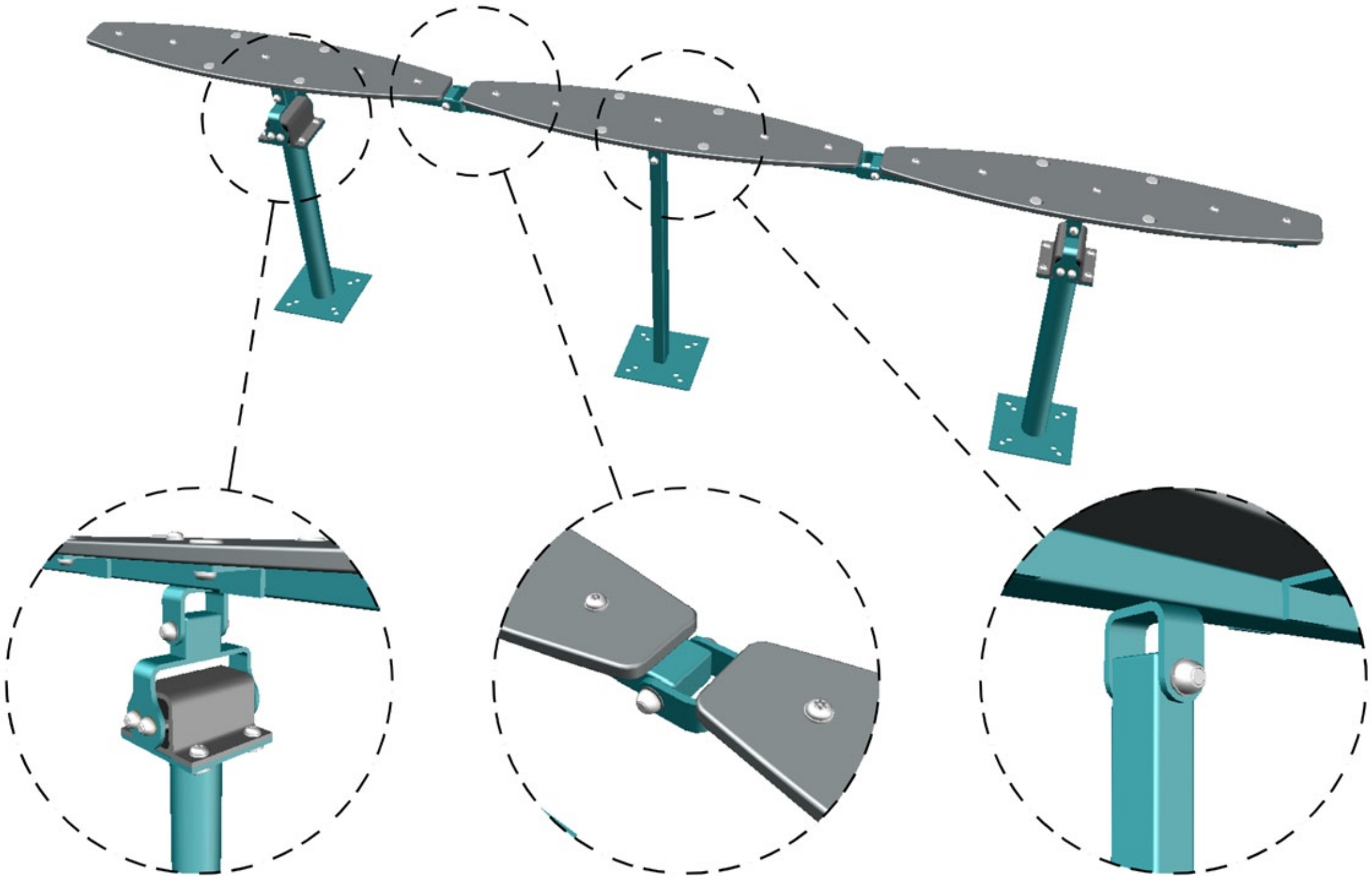

RP001 eXigo Rope Bridge Exploded View (Xi009)

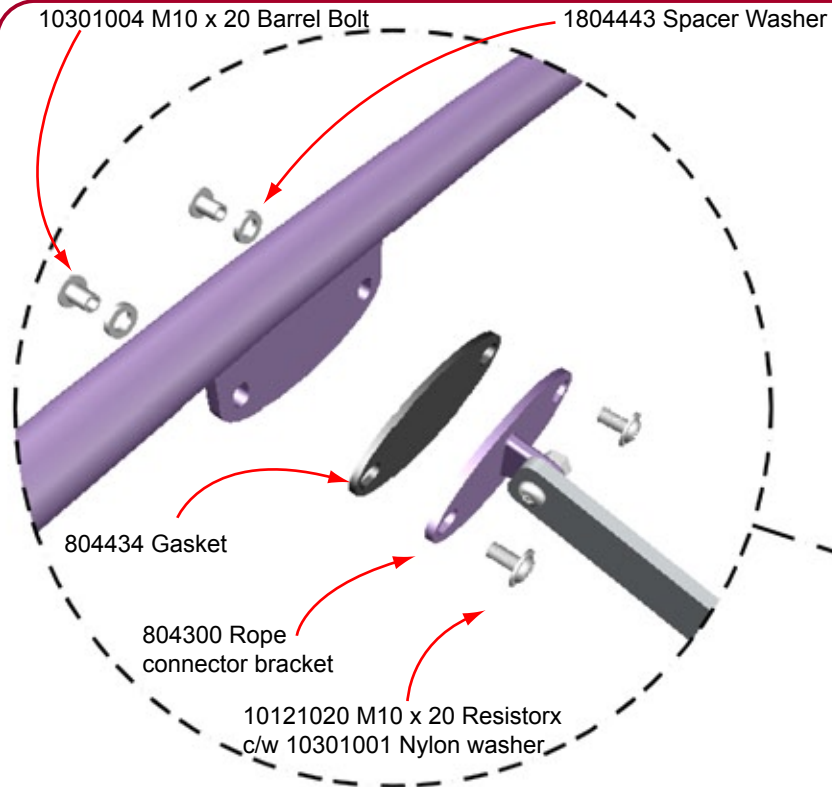

- Assembly Sequence: -
1. Assemble unit as indicated in the previously excavated footings (see footing layout for details).
 2. Once the rest of the system has been correctly assembled back fill footings with Concrete @ 4:2:1 mix.
 3. Allow concrete to cure before fitting the rope nets

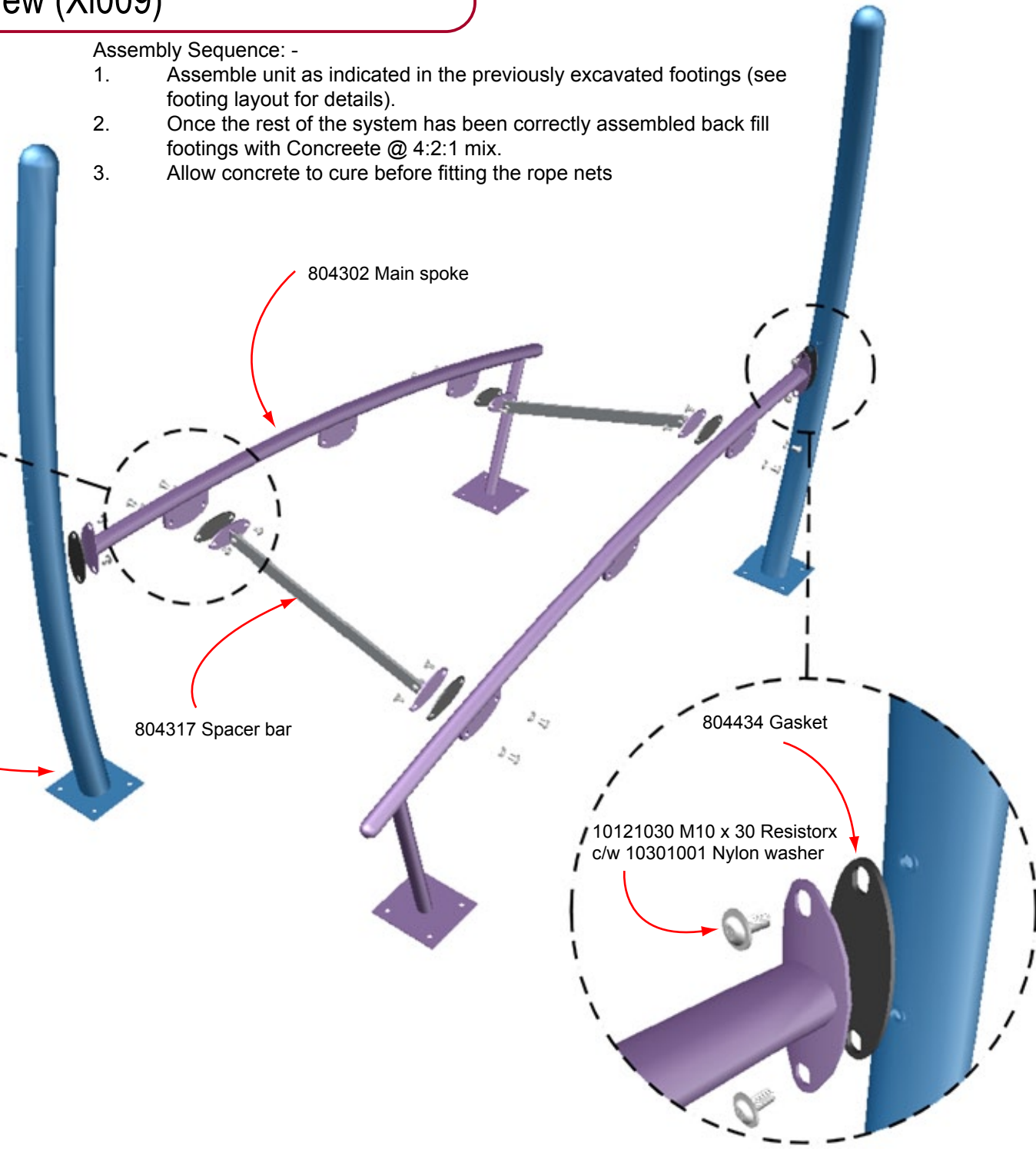

Xi009 Rope Bridge		
Code	Description	No Off
804300	Rope Connector Bracket	6
804302	Main Spoke	2
804304	Main Upright Post	2
804317	Rope Spacer Bar	2
804434	Elliptical Neoprene Gasket	8
804443	5mm Thick Spacer Washer	12
804500	Rope Bridge Net	1
10121020	M10 x 20 Resistorx	12
10121030	M10 x 30 Resistorx	4
10251030	M10 x 30 Hex Head Bolt	4
10271000	M10 Plain Nut	4
10301001	M10 Nylon Washer	16
10301004	M10 x 20 Barrel Bolt	12

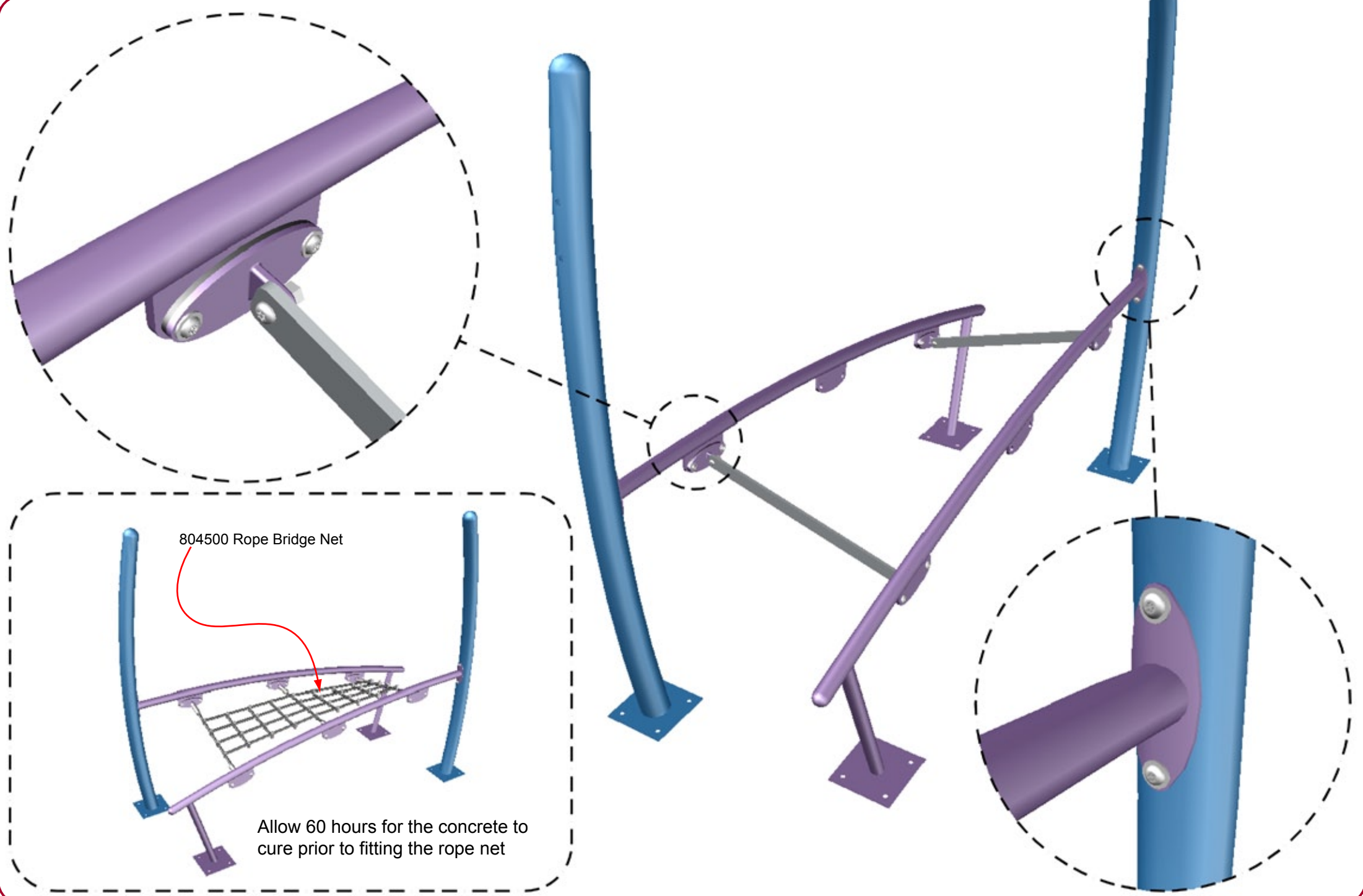

804500 Rope Bridge Net

Allow 60 hours for the concrete to cure prior to fitting the rope net

RP001 eXigo PlankWalk Exploded View (Xi010)

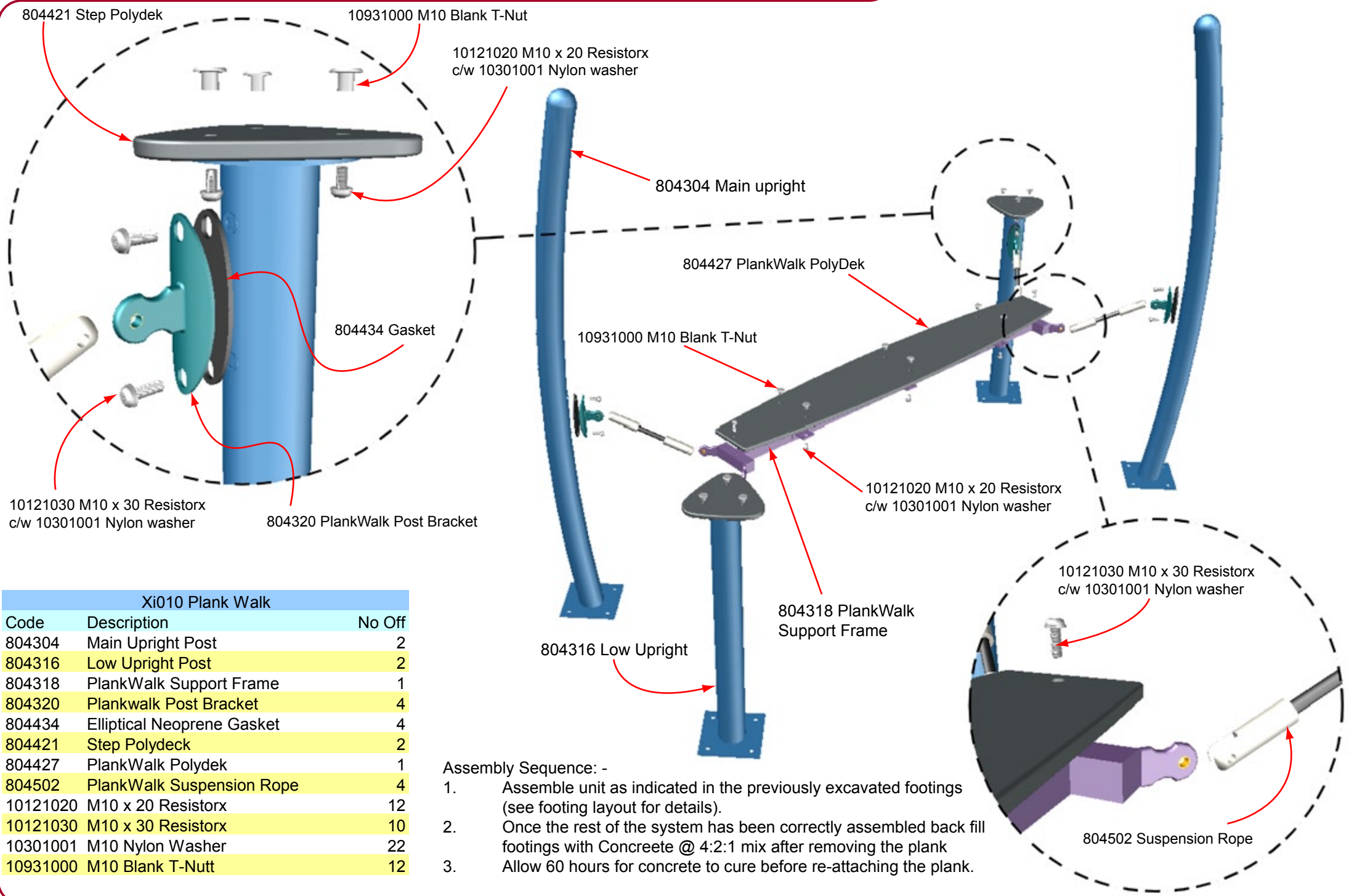

Xi010 Plank Walk		
Code	Description	No Off
804304	Main Upright Post	2
804316	Low Upright Post	2
804318	PlankWalk Support Frame	1
804320	Plankwalk Post Bracket	4
804434	Elliptical Neoprene Gasket	4
804421	Step Polydeck	2
804427	PlankWalk Polydek	1
804502	PlankWalk Suspension Rope	4
10121020	M10 x 20 Resistorx	12
10121030	M10 x 30 Resistorx	10
10301001	M10 Nylon Washer	22
10931000	M10 Blank T-Nutt	12

- Assembly Sequence: -
1. Assemble unit as indicated in the previously excavated footings (see footing layout for details).
 2. Once the rest of the system has been correctly assembled back fill footings with Concrete @ 4:2:1 mix after removing the plank
 3. Allow 60 hours for concrete to cure before re-attaching the plank.

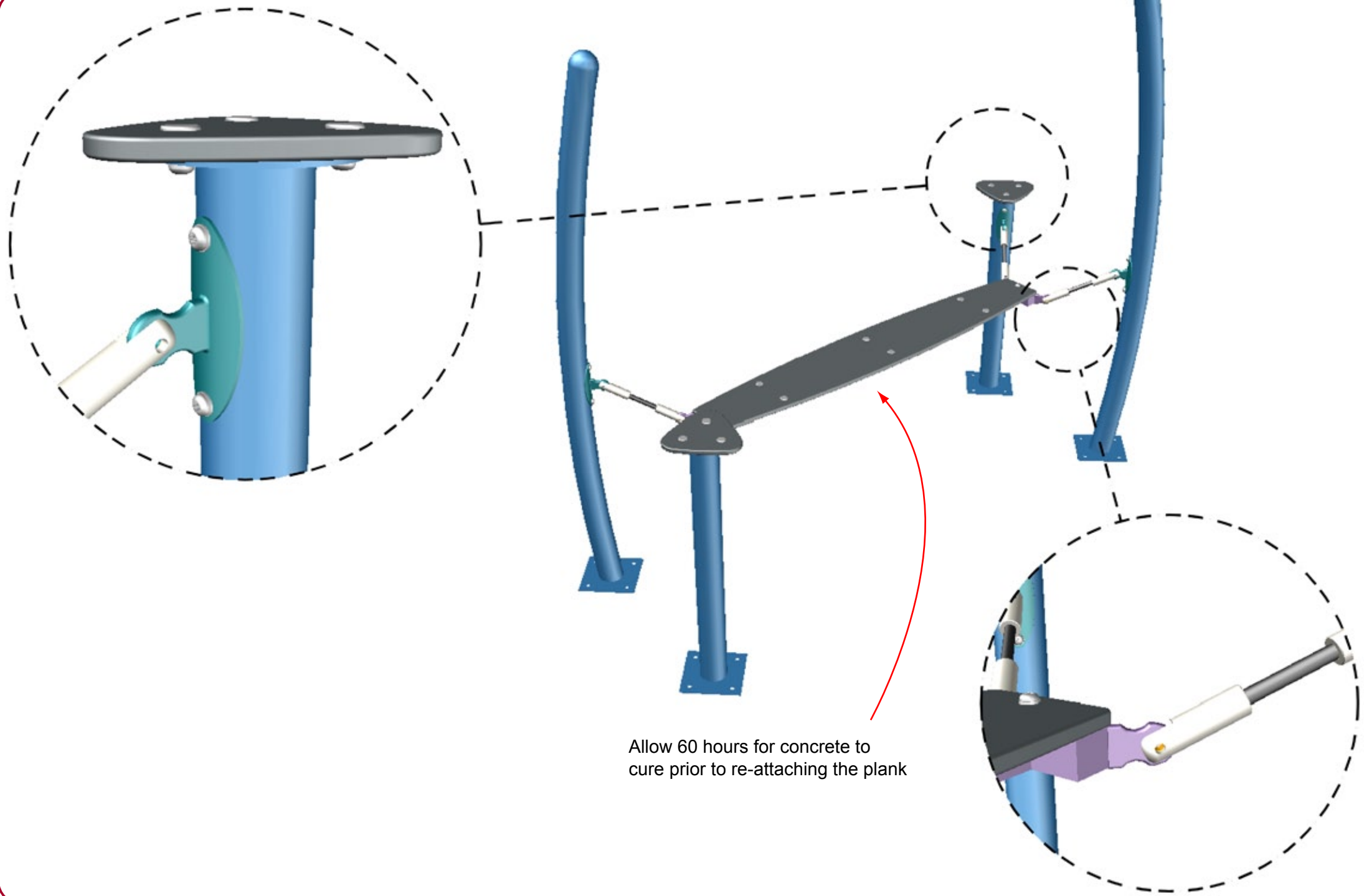

Allow 60 hours for concrete to cure prior to re-attaching the plank

RP001 eXigo Optional Play Panel Assembly

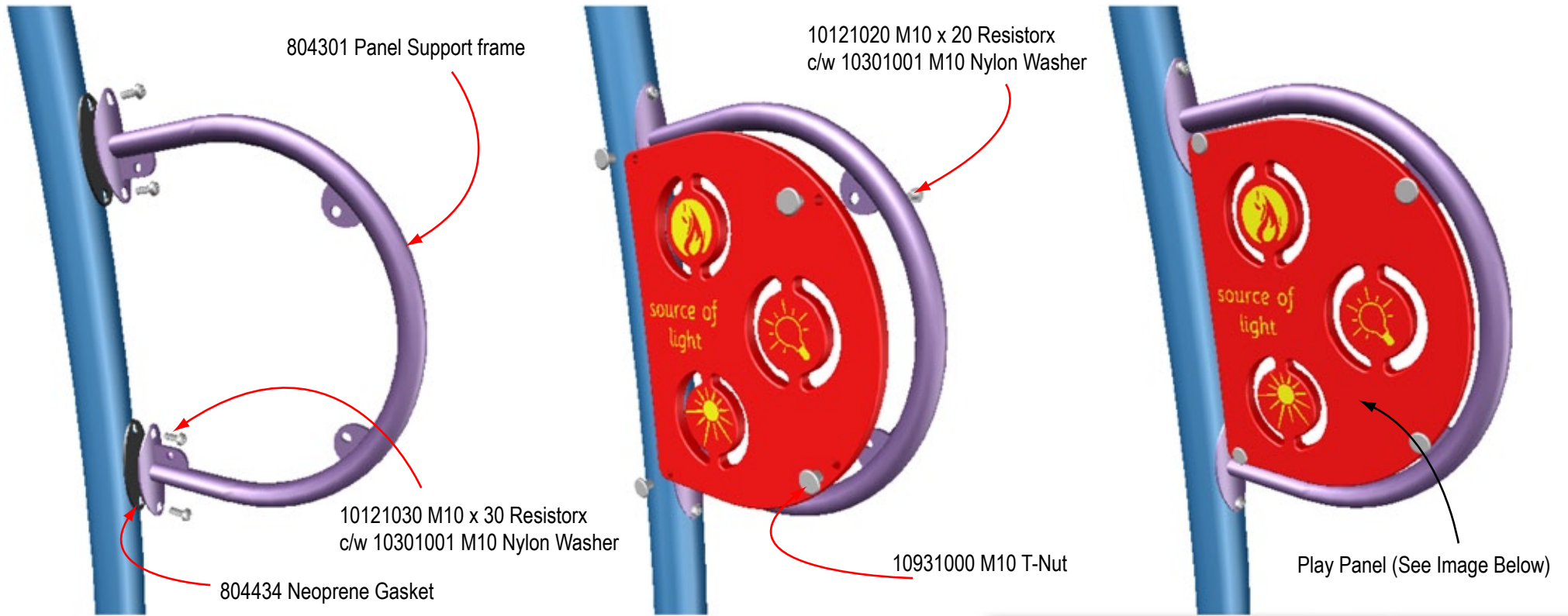

Play Panel Components		
Code	Description	No Off
804301	Panel Support Frame	1
804117*	2D/3D Objects Panel Assembly	1
804450*	Sight Sound Panel	1
804451*	Hello Language	1
804434	Noeprene Gasket	2
10121020	M10 x 20 Resistorx	4
10121030	M10 x 30 Resistorx	4
10301001	M10 Nylon Washer	8
10931000	M10 Blank T-nut	4
* One Panel per assembly		

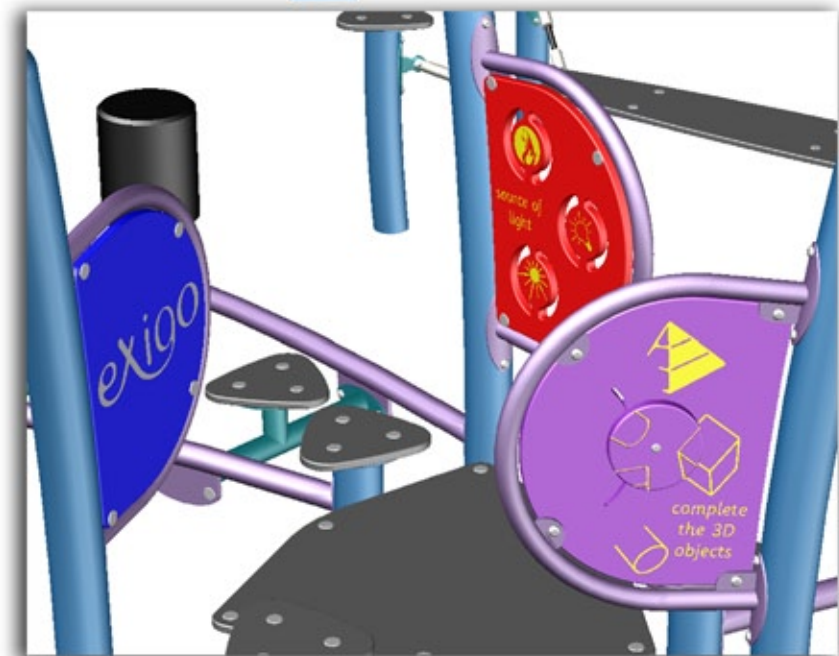



RP001 eXigo Sub Assembly - 804107 Medium Pivot Pad.

804423 Medium Pivot Pad Polydek
Ensure rubber surface is top side

10931000 M10 Blank T-Nut

10121020 M10 x 20 Resistorx
c/w 10301001 M10 Nylon Washers

804314 Medium Pivot Pad
Support Plate

804435 AK38 Suspension Unit

804440 170mm Long M10 studded bar
c/w 10281001 M10 Kinmar Nuts &
10301000 M10 Shakeproof Washers

804310 Seesaw Bar Medium

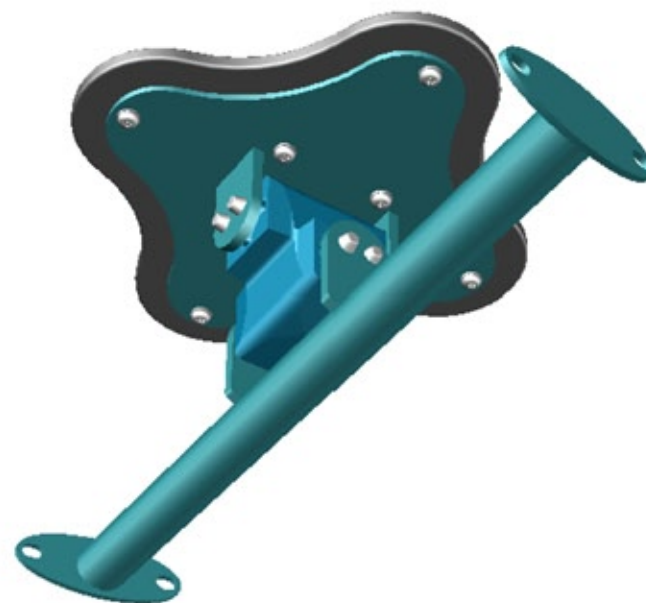

804107 Medium PivotPad Assembly		
Code	Description	No Off
804310	Seesaw Bar Medium	1
804314	Medium Pivotpad Support Plate	1
804423	Medium Pivotpad Polydek	1
804440	170mm Long Studded Bar	4
804435	AK-38 Suspension Unit	1
10121020	M10 x 20 Resistorx	8
10281001	M10 Kinmar Nuts	8
10301000	M10 Shake proof washer	8
10301001	M10 Nylon Washer	8
10931000	M10 Blank T-nut	8



RP001 eXigo Sub Assembly - 804108 Large Pivot Pad.

10931000 M10 Blank T-Nut

804422 Medium Pivot Pad Polydek
Ensure rubber surface is top side

10121020 M10 x 20 Resistorx
c/w 10301001 M10 Nylon Washers

804315 Large Pivot Pad
Support Plate

804435 AK38 Suspension Unit

804440 170mm Long M10 studded bar
c/w 10281001 M10 Kinmar Nuts &
10301000 M10 Shakeproof Washers

804311 Seesaw Bar Long

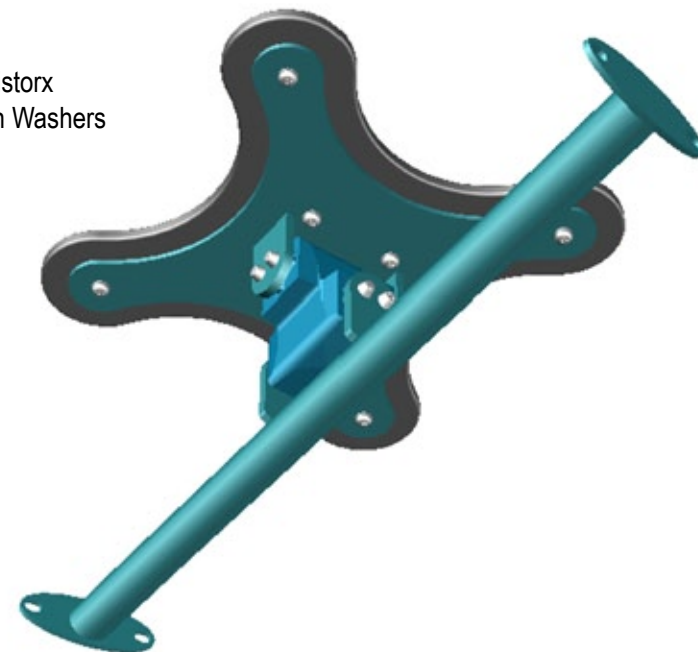

804108 Large PivotPad Assembly		
Code	Description	No Off
804311	Seesaw Bar Long	1
804315	Large Pivotpad Support Plate	1
804422	Large Pivotpad Polydek	1
804440	170mm Long Studded Bar	4
804435	AK-38 Suspension Unit	1
10121020	M10 x 20 Resistorx	8
10281001	M10 Kinmar Nuts	8
10301000	M10 Shake proof washer	8
10301001	M10 Nylon Washer	8
10931000	M10 Blank T-nut	8



RP001 eXigo Sub Assembly - 804109 Small Static Board Assembly

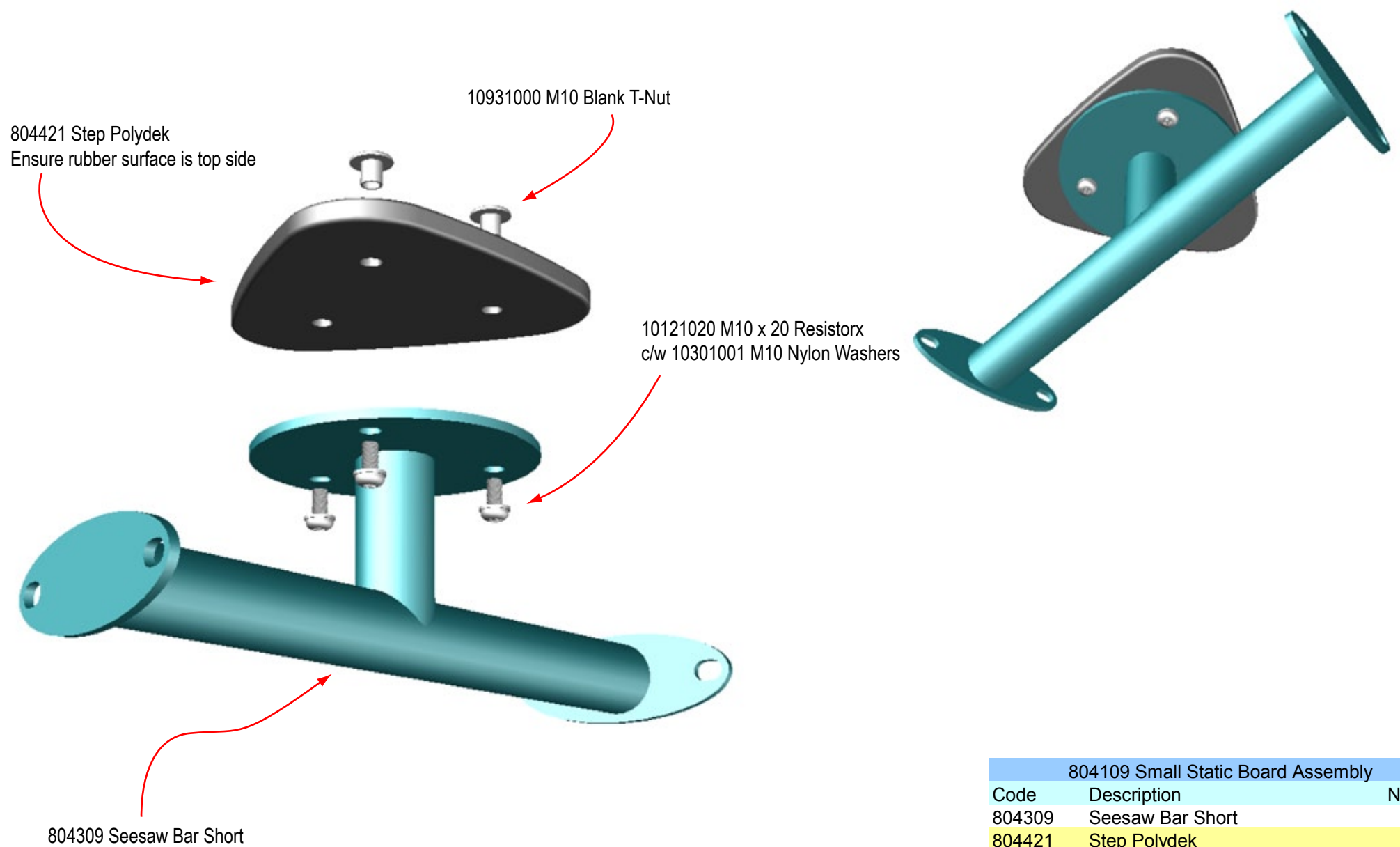

804109 Small Static Board Assembly		
Code	Description	No Off
804309	Seesaw Bar Short	1
804421	Step Polydek	1
10121020	M10 x 20 Resistorx	3
10301001	M10 Nylon Washer	3
10931000	M10 Blank T-nut	3



RP001 eXigo Sub Assembly - 804110 Medium Seesaw Board.

804429 Medium Seesaw Polydek
Ensure rubber surface is top side

10931000 M10 Blank T-Nut

10121020 M10 x 20 Resistorx
c/w 10301001 M10 Nylon Washers

804436 DW-A 38 x 120 Suspension Unit

10121030 M10 x 30 Resistorx
c/w 10301001 M10 Nylon Washers

804440 170mm Long M10 studded bar
c/w 10281001 M10 Kinmar Nuts &
10301000 M10 Shakeproof Washers

804402 Medium Polydek Support Plate

804310 Seesaw Bar Medium

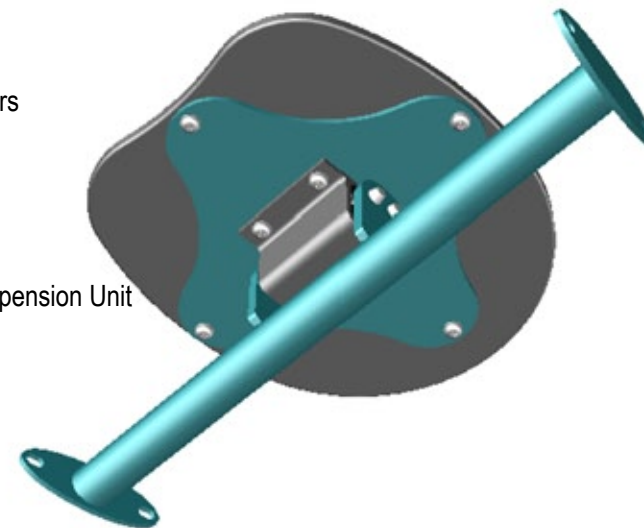

804110 Medium Seesaw Board Assembly		
Code	Description	No Off
804310	Seesaw Bar Medium	1
804402	Medium Polydek support Plate	1
804429	Medium Seesaw Polydek	1
804440	170mm Long Studded Bar	2
804436	DW-A 38 x 120 Suspension Unit	1
10121020	M10 x 20 Resistorx	4
10121030	M10 x 30 Resistorx	4
10281001	M10 Kinmar Nuts	4
10301000	M10 Shakeproof Washer	4
10301001	M10 Nylon Washer	8
10931000	M10 Blank T-nut	8



RP001 eXigo Sub Assembly - 804111 Large Seesaw Board.

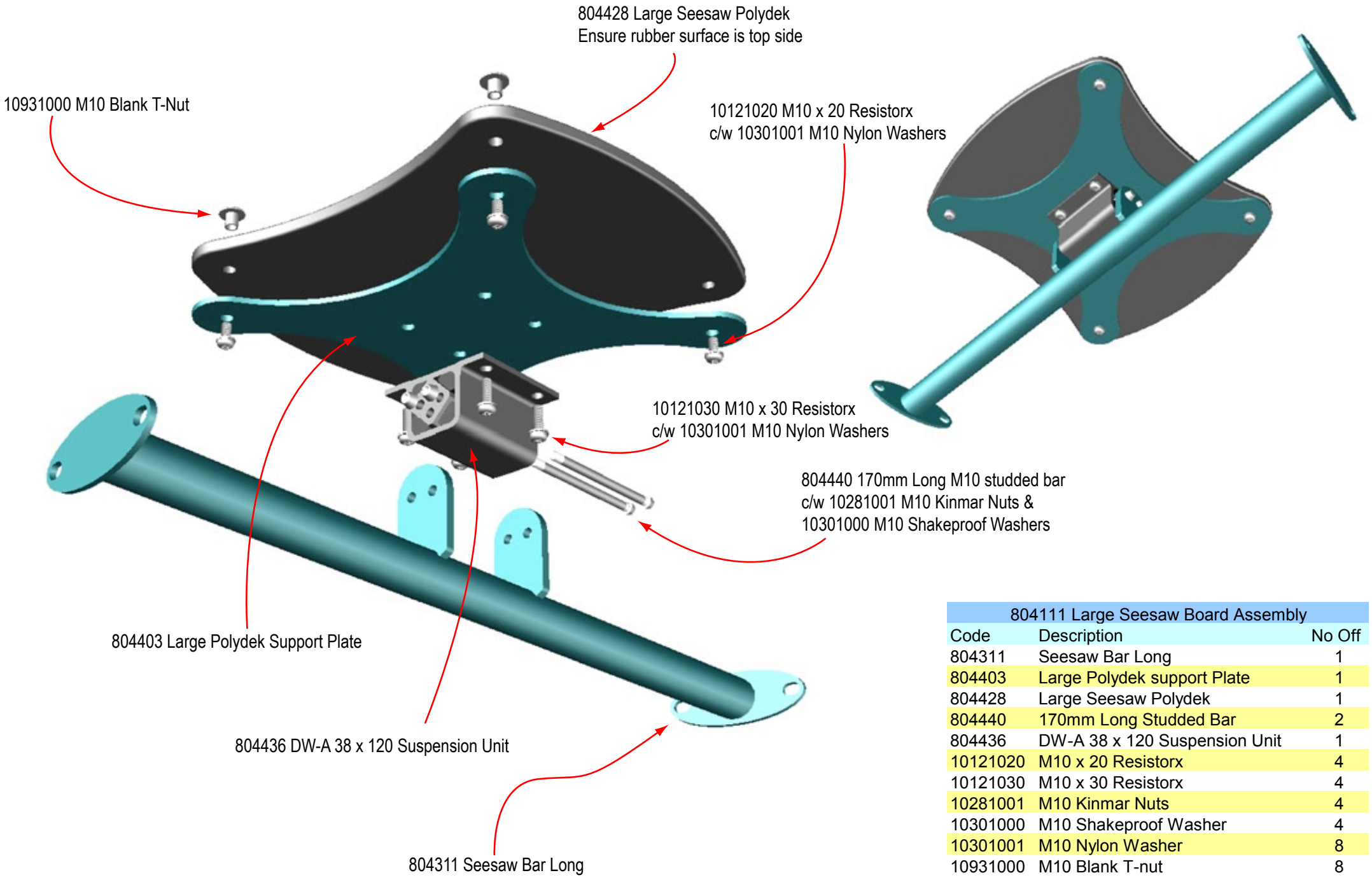

804111 Large Seesaw Board Assembly		
Code	Description	No Off
804311	Seesaw Bar Long	1
804403	Large Polydek support Plate	1
804428	Large Seesaw Polydek	1
804440	170mm Long Studded Bar	2
804436	DW-A 38 x 120 Suspension Unit	1
10121020	M10 x 20 Resistorx	4
10121030	M10 x 30 Resistorx	4
10281001	M10 Kinmar Nuts	4
10301000	M10 Shakeproof Washer	4
10301001	M10 Nylon Washer	8
10931000	M10 Blank T-nut	8

RP001 eXigo Sub Assembly - 804112 Wobbleboard.

10931000 M10 Blank T-Nut

804425 Wobbleboard Polydek
Ensure rubber surface is top side

10121020 M10 x 20 Resistorx
c/w 10301001 M10 Nylon Washers

10121030 M10 x 30 Resistorx
c/w 10301001 M10 Nylon Washers

804404 Wobbleboard Polydek Support Plate

804440 170mm Long M10 studded bar
c/w 10281001 M10 Kinmar Nuts &
10301000 M10 Shakeproof Washers

804436 DW-A 38 x 120 Suspension Unit

804303 Wobbleboard Support Frame

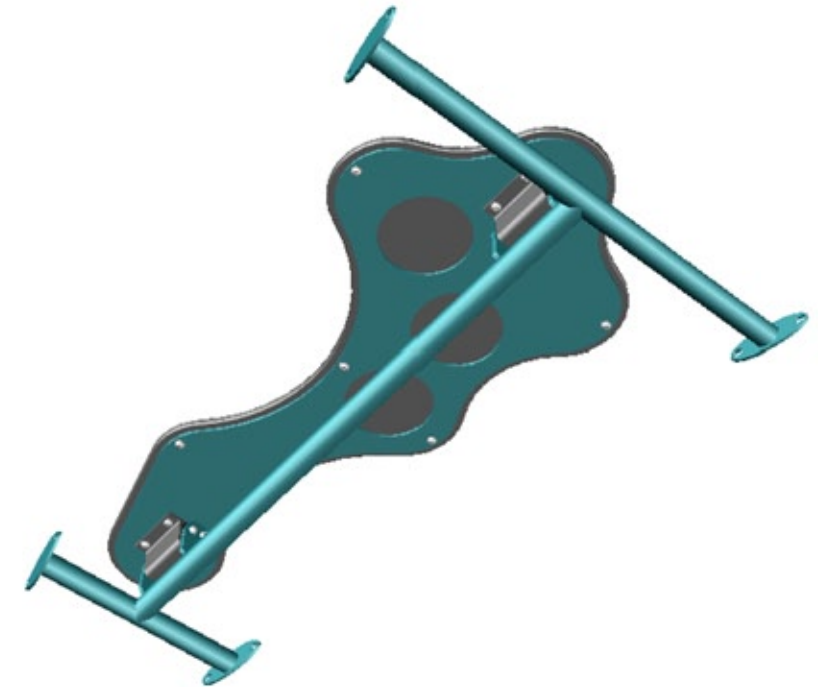

804112 Wobbleboard Board Assembly		
Code	Description	No Off
804303	Wobbleboard Support Frame	1
804404	Wobbleboard Polydek support plate	1
804425	Wobbleboard Polydek	1
804440	170mm Long Studded Bar	4
804436	DW-A 38 x 120 Suspension Unit	2
10121020	M10 x 20 Resistorx	5
10121030	M10 x 30 Resistorx	8
10281001	M10 Kinmar Nuts	8
10301000	M10 Shakeproof Washer	8
10301001	M10 Nylon Washer	13
10931000	M10 Blank T-nut	13



RP001 eXigo Sub Assembly - 804113 WaveWalk End Support.

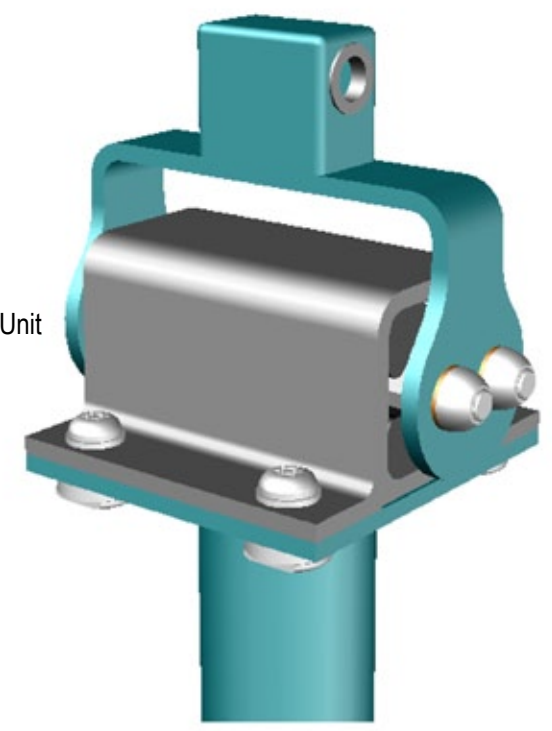
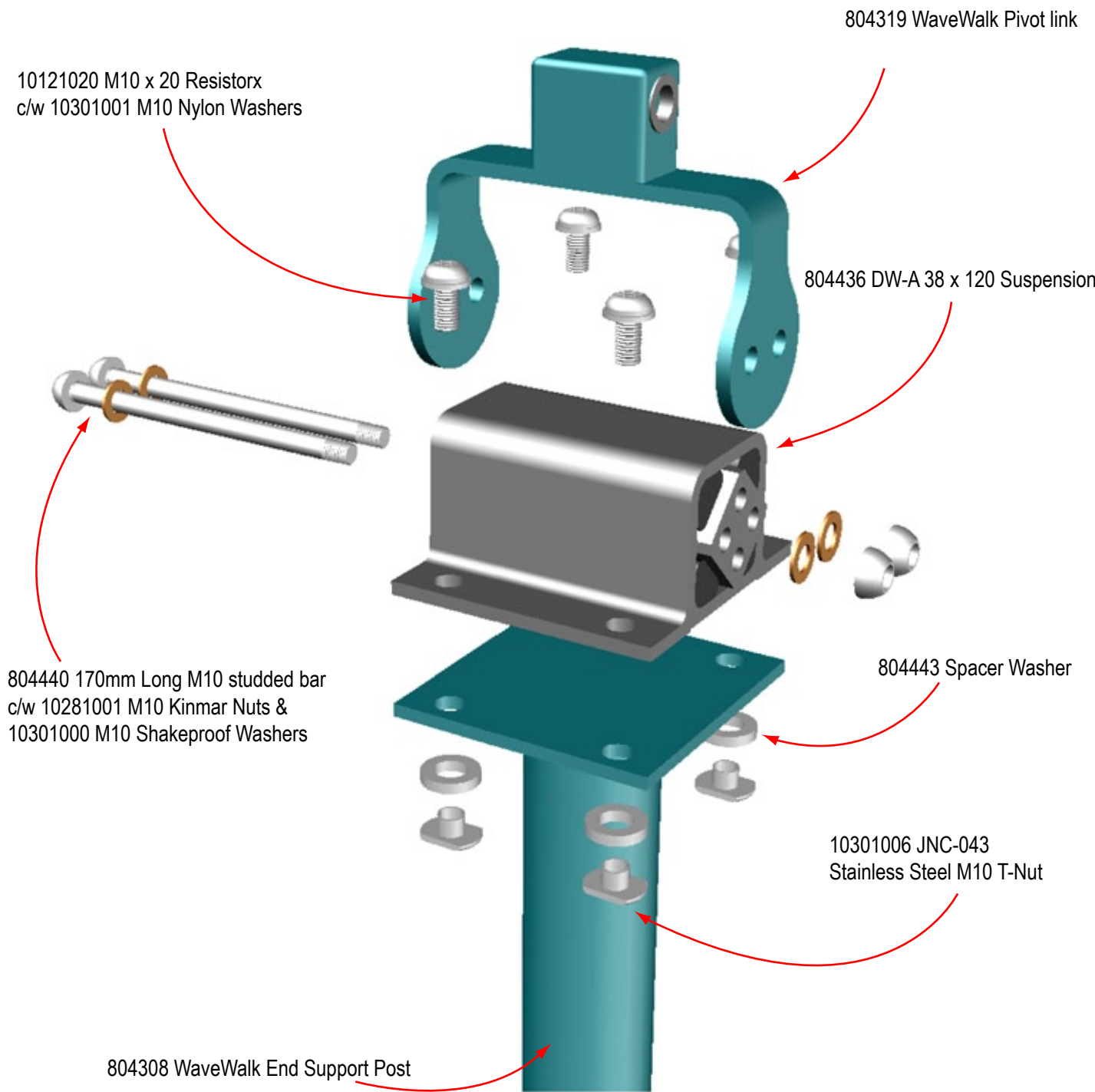

804113 WaveWalk End Support Post Assembly		
Code	Description	No Off
804308	WaveWalk End Support Post	1
804319	WaveWalk Pivot Link	1
804436	DW-A 38 x 200 Suspension Unit	1
804440	170mm Long M10 Studded Bar	2
804443	5mm Spacer Washer	4
10121020	M10 x 20 Resistorx	4
10281001	M10 Kinmar Nuts	4
10301000	M10 Shakeproof Washer	4
10301001	M10 Nylon Washer	4
10301006	JNC-043 SS M10 T-Nut	4



RP001 eXigo Sub Assembly - 804117 2D-3D Shapes Panel Assembly.

804452 Complete 2D/3D Objects Panel

Press Fit into the front of each disc the 804442 M6 Insert Nut. Use Araldite in each of the nuts to secure the M6 Studded bar and ensure the discs are free to rotate without unscrewing

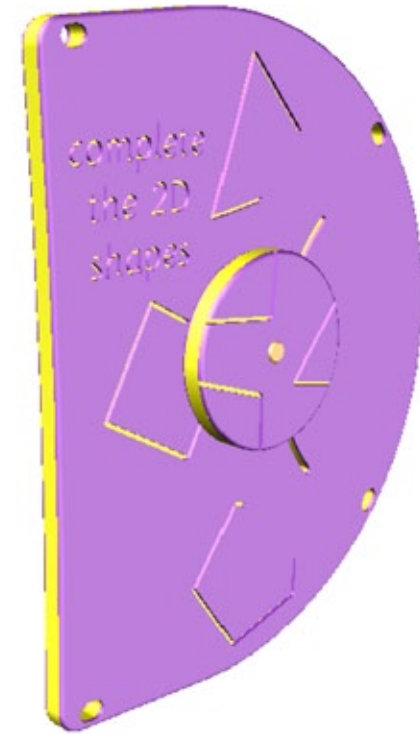
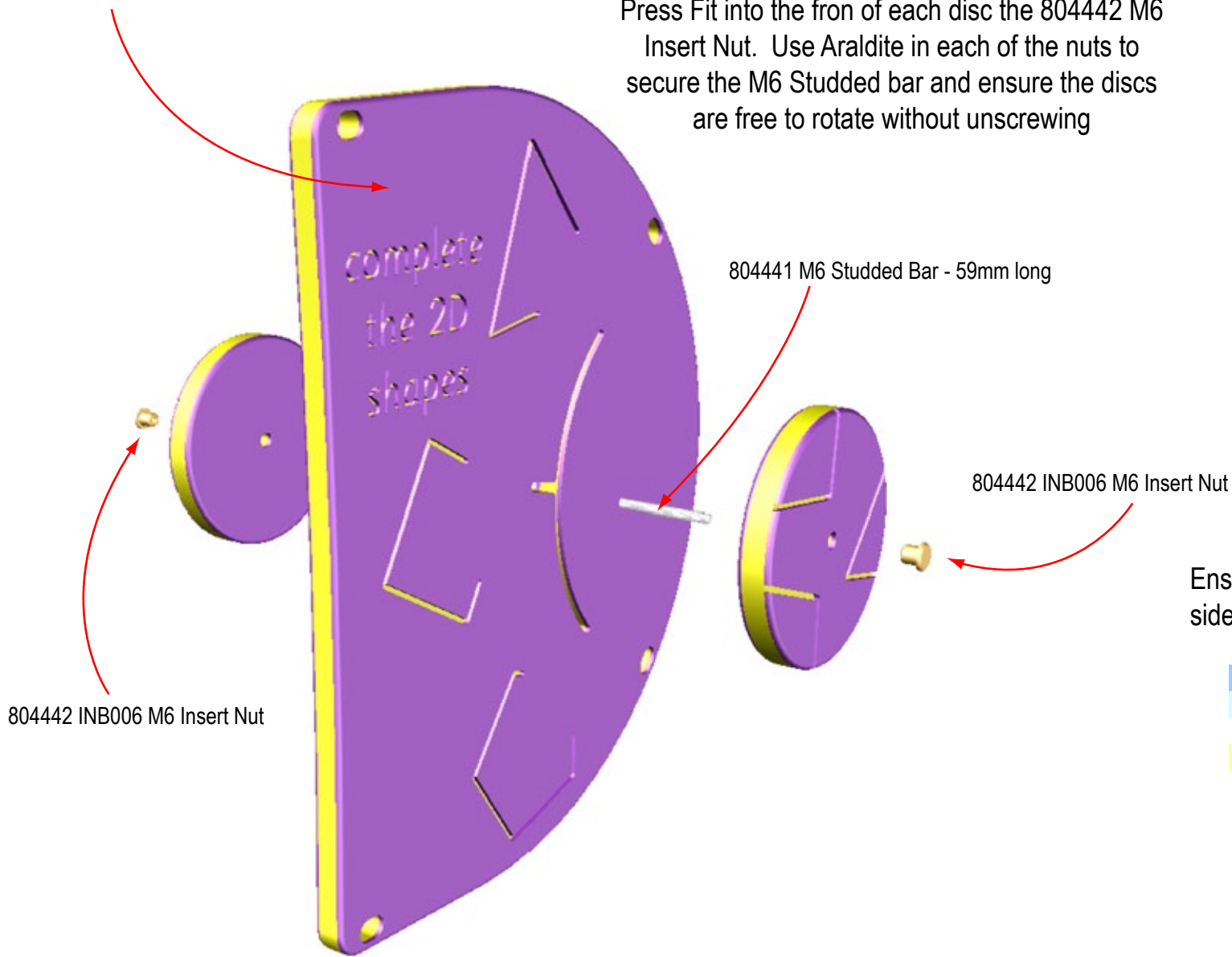

Ensure the correct disc is aligned with the correct side of the main panel, see assembled view above

804117 2D-3D Shapes Panel Assembly		
Code	Description	No Off
804441	M6 Studded Bar-59mm Long	1
804442	INB006 M6 Insert Nut	2
804452	Complete 2D/3D Objects Panel	1

RP001 eXigo Inspection & Maintenance Schedule

All play equipment should be maintained in accordance with EN1176 Part 1. The frequency of inspection will vary with the type of equipment or materials used and other factors, e.g. heavy use, levels of vandalism, coastal location, air pollution and age of equipment. Should you require additional information or assistance please contact our office on 01757 703620.

Routine Visual Inspection (WEEKLY)

Check For: Structural integrity
 Excessive wear of moving parts
 Missing parts
 Sharp edges
 Exposed foundations
 Ground clearances
 Cleanliness
 Ground surface finishes
 Damage to rope components i.e. fraying exposing steel core

***For playgrounds utilizing Loosefil Surfacing, ensure level of surfacing is maintained at the level mark.
For playgrounds subject to heavy use or vandalism, daily inspection is advised.***

Operational Inspection (1 TO 3 MONTHS)

Check For: All the foregoing
 No trip points or obstructions within the falling space
 Attention should be given to 'sealed for life' parts
 Check moving components for wear and tear, and lubricate as required
 Tension of rope bridge & Inclined rope climbers

Annual Main Inspection (NOT EXCEEDING 12 MONTHS)

Check For: All the foregoing
 Effects of weather
 Rotting or corrosion
 A change in the level of safety of the equipment as a result of repairs made, or of added or replaced components

ALL REPLACEMENT PARTS SHALL COMPLY WITH RECORD RSS LIMITED SPECIFICATIONS. SEE INSTALLATION INSTRUCTIONS AND TABLE ABOVE RIGHT FOR COMPONENT REFERENCE NUMBERS

Code	Description	No Off
Xi005	Central Deck	1
Xi006	Pivot Pad Spoke	1
Xi007	Seesaw Board Spoke	1
Xi008	Wobble Board Spoke	1
Xi009	Rope Bridge	1
Xi010	Plank Walk	1
Xi011	WaveWalk	1
RYBL200	200mm High Bollard	6
RYBL300	300mm High Bollard	7
RYBL400	400mm High Bollard	2

Please refer to the individual parts list associated with each of the above elements located throughout this guide for identifying spare parts.