



MIRACLE
RECREATION EQUIPMENT COMPANY

Installation Guide

November 9, 2012

Rev. B

DNA Climber with Rope

IMPORTANT! Prior to installation of any components, refer to **Playsystem Installation Guidelines and Tips** in the *Install 101* section of your manual. This section will provide important tips pertaining to **site preparation, footings, system stabilization,** and other necessary information **vital to the success of your installation.**

Top View

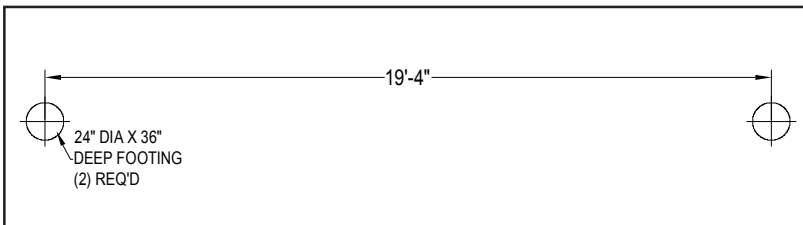
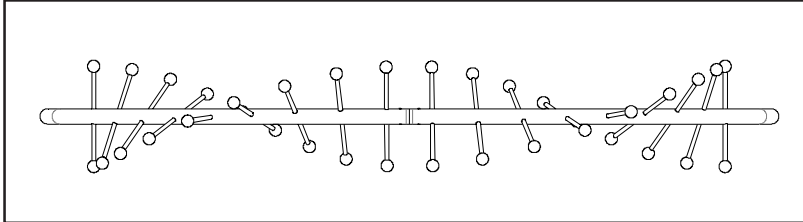

Footing Layout

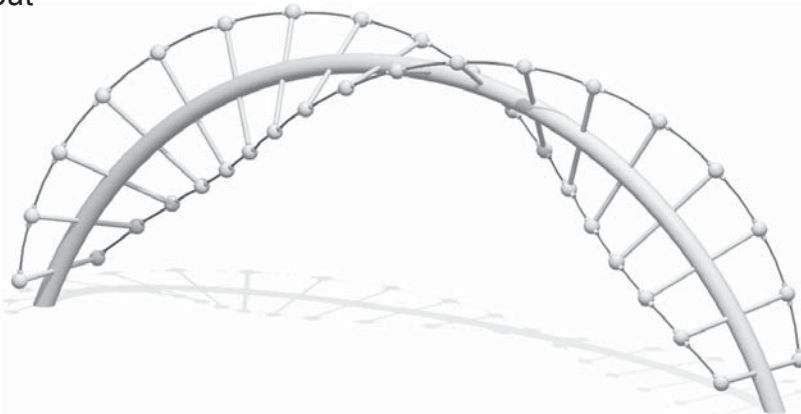

461R

**DNA Climber
with Rope**

DNA Climber with Rope

TOOLS AND EQUIPMENT REQUIRED

Also see 'Suggested Tools & Equipment' (Doc. # D70052) in "Installations 101"

1. Concrete for footings, wheelbarrow or mixer, 5 gallon bucket, water supply
2. Digging equipment for footings (spade shovel, post hole digger, auger)
3. Bracing materials (2x4s, sawhorses, etc.)
4. Tape measure and level
5. Open end wrench set, Allen and 6-lobe wrenches or bits, socket set, screwdrivers
6. Drill, bits, extension cords, power supply
7. Step ladder
8. Adult installers - 2 minimum

461R

DNA Climber with Rope

STEP 1 DIG FOOTINGS

Refer to *Footing Details*. Dig two (2) 24" diameter x 36" deep footings.

STEP 2 SET SWAGED ARCH SPLICE INTO ARCH HALF

Locate P/N 996233, Arch Splice. Insert into end of one Arch half and line up bolt holes in Splice and Arch. Bolt Splice to Arch Half via 3/8" bolts.

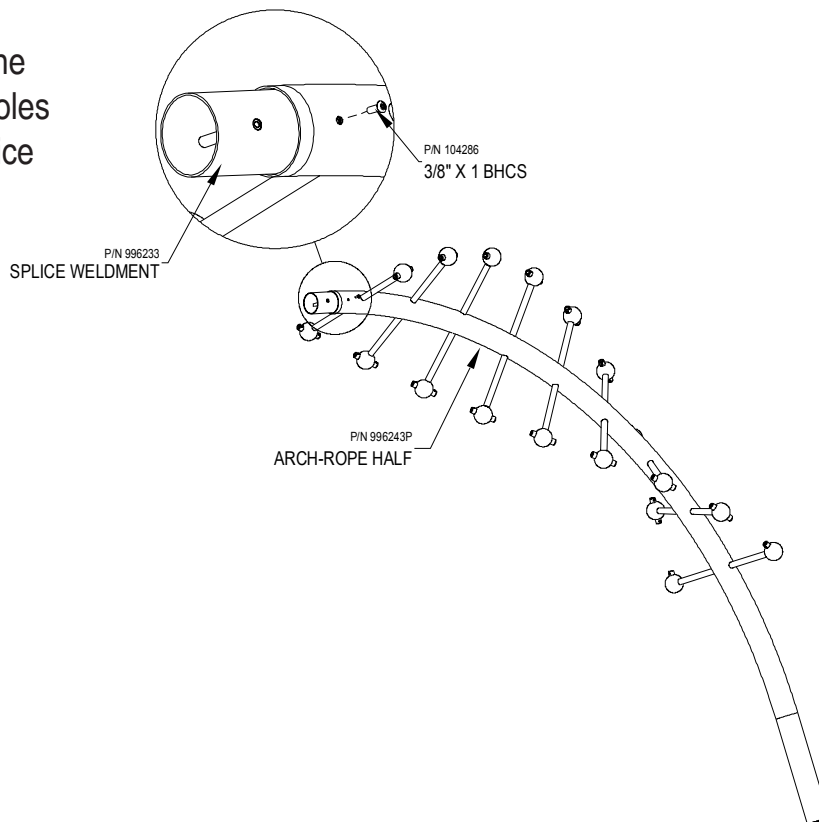

STEP 3 ATTACH SECOND ARCH HALF TO FIRST VIA SPLICE

Slide end of second Arch into Splice. Ensure Arch is firmly seated in Splice and there are no gaps between Arch halves. Line up bolt holes and secure with 3/8 x 16 bolts.

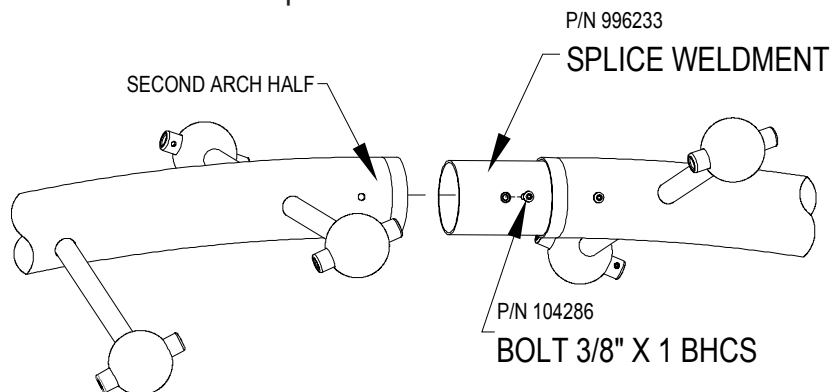



MIRACLE[®] DNA Climber with Rope

RECREATION EQUIPMENT COMPANY

STEP 4 THREAD ROPE ONTO ARCH

Beginning at one end, thread Rope into first sphere approximately 4" or until you feel the Rope bottom out inside the Sphere. Attach using **1/2" x 3/8" set screws**.

Continue threading Rope one section at a time, tightening Rope at each section before securing with set screws.

It will be necessary to cut off any remaining rope at last connection point so that Rope ends approximately 4" inside last Sphere.

Repeat all steps for second Rope.

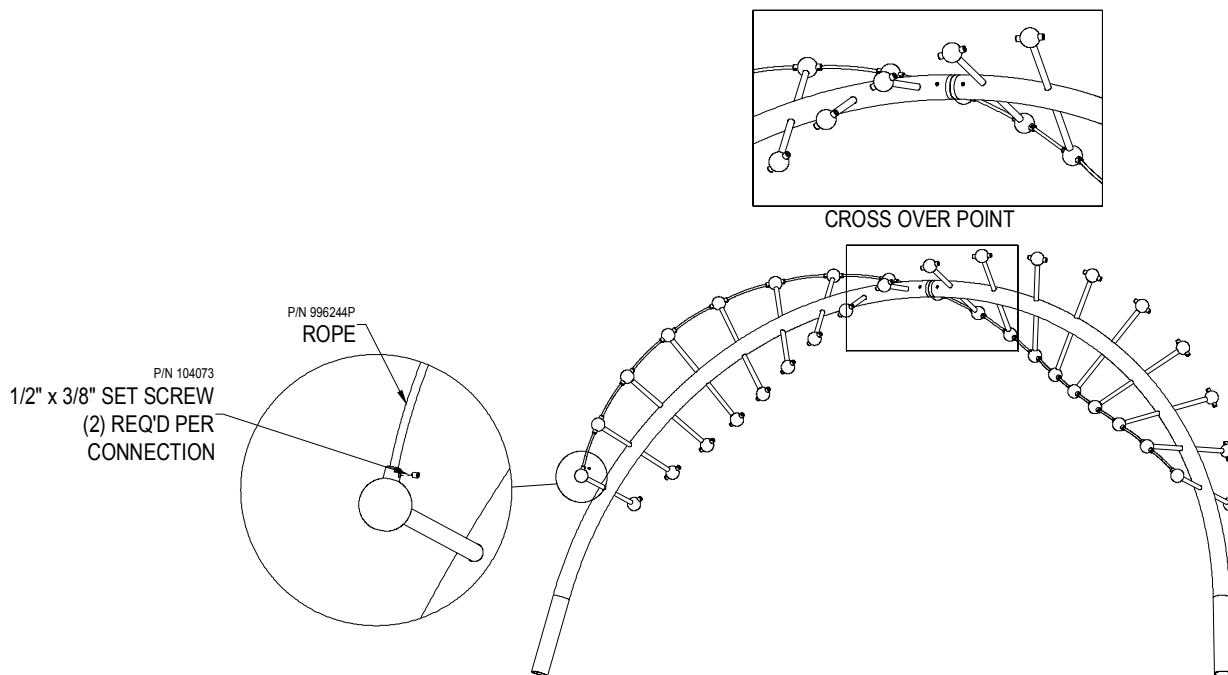

DNA Climber with Rope

STEP 5 RAISE ARCH AND SET INTO FOOTINGS

Raise Arch and place Legs into footings. Brace into position level and plumb. Pour concrete and allow to cure for 72 hours prior to allowing play.

Bill of Materials

QUANTITY	PART NUMBER	DESCRIPTION
----------	-------------	-------------

MODEL # 461R DNA CLIMBER WITH ROPE

2	996243P	ARCH-ROPE HALF
1	996236	PARTS CARTON 461
1	986348	PARTS CARTON - GENERIC AND WARNING LABELS
1	994991	PARTS CARTON - 5-12 LABEL
1	999033P	PARTS CARTON - TOUCH-UP PAINT-POST
1	996248P	PARTS CARTON 461R

PARTS CARTON # 996236

4	104286	BOLT 3/8-16 X 1 BHCS 6 LOBE 18-8 SS
1	996233	SPLICE WELDMENT

PARTS CARTON # 996248P

72	104073	BOLT 3/8-16 X 1/2 SET SKT 18-8 SS
2	996244P	ROPE-DNA CLIMBER